

LA PALMA BUSINESS CENTER
INDUSTRIAL FOR LEASE

— 2511-2521 La Palma Ave., Anaheim, CA

LEE & ASSOCIATES
COMMERCIAL REAL ESTATE SERVICES
±46,580 SF



PROPERTY HIGHLIGHTS

- Industrial Park Environment
- 46,580 Square Feet
- 2 Buildings
- 720 - 2,400 SF Spaces
- 14' Ceiling Height
- Office Space in Unit
- 1-Story
- Light Industrial Zone
- Lease Terms as Acceptable to Owner
- Freeway Access to 91 and I-5 Freeways

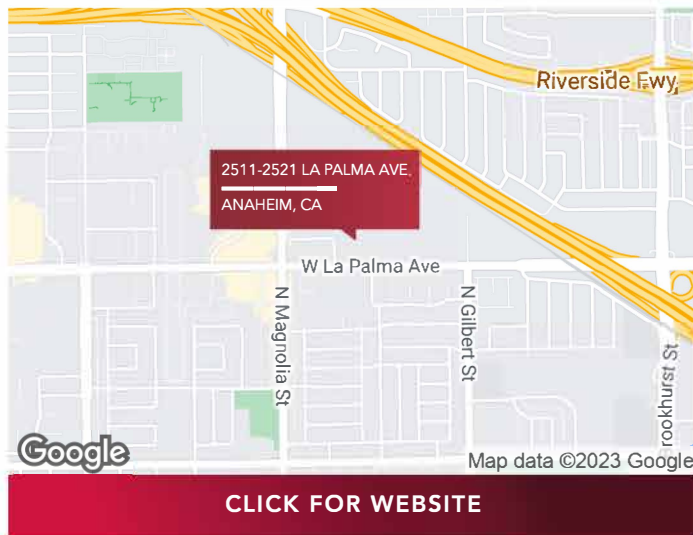

[CLICK FOR WEBSITE](#)

Jim Hawkins

PRINCIPAL

+714.564.7126

jhawkins@lee-associates.com

DRE# 00833274

1004 West Taft Avenue, Suite 150 | Orange, CA 92865 | 714.647.9100 | lee-associates.com/orange/ | DRE# 01011260



All information furnished regarding property for sale, rental or financing is from sources deemed reliable, but no warranty or representation is made to the accuracy thereof and same is submitted to errors, omissions, change of price, rental or other conditions prior to sale, lease or financing or withdrawal without notice. No liability of any kind is to be imposed on the broker herein.

2511 - 2521 La Palma Sample Floor Plans

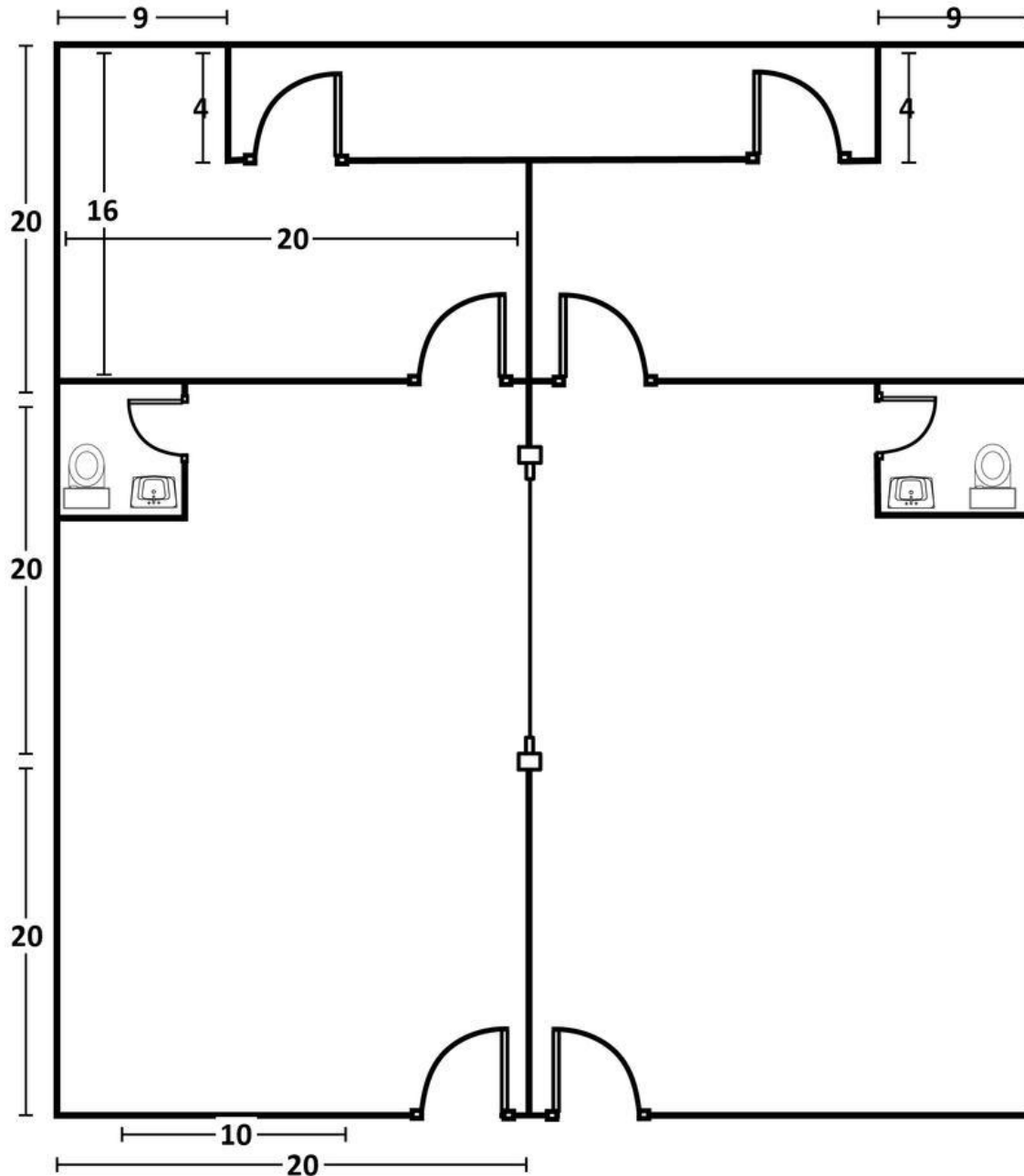

Jim Hawkins

PRINCIPAL

+714.564.7126

jhawkins@lee-associates.com

DRE# 00833274

SITE PLAN

— 2511-2521 La Palma Ave., Anaheim, CA

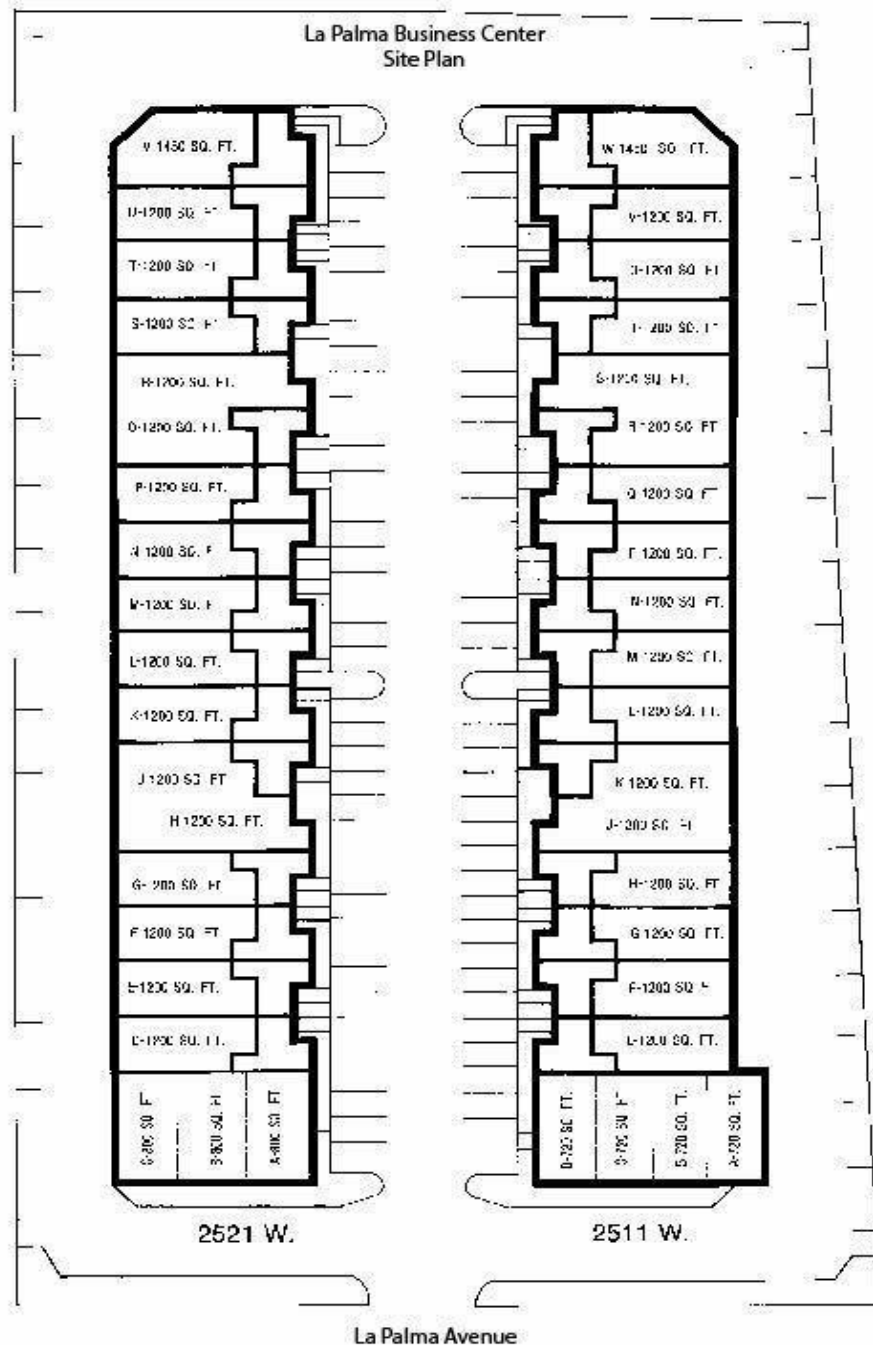

Jim Hawkins

PRINCIPAL

+714.564.7126

jhawkins@lee-associates.com

DRE# 00833274

LA PALMA BUSINESS CENTER
LOCATION MAPS

— 2511-2521 La Palma Ave., Anaheim, CA

LEE & ASSOCIATES
COMMERCIAL REAL ESTATE SERVICES
±46,580 SF



Jim Hawkins

PRINCIPAL

+714.564.7126

jhawkins@lee-associates.com

DRE# 00833274

1004 West Taft Avenue, Suite 150 | Orange, CA 92865 | 714.647.9100 | lee-associates.com/orange/ | DRE# 01011260



All information furnished regarding property for sale, rental or financing is from sources deemed reliable, but no warranty or representation is made to the accuracy thereof and same is submitted to errors, omissions, change of price, rental or other conditions prior to sale, lease or financing or withdrawal without notice. No liability of any kind is to be imposed on the broker herein.

LA PALMA BUSINESS CENTER
DEMOGRAPHICS MAP

— 2511-2521 La Palma Ave., Anaheim, CA

LEE & ASSOCIATES
 COMMERCIAL REAL ESTATE SERVICES
±46,580 SF

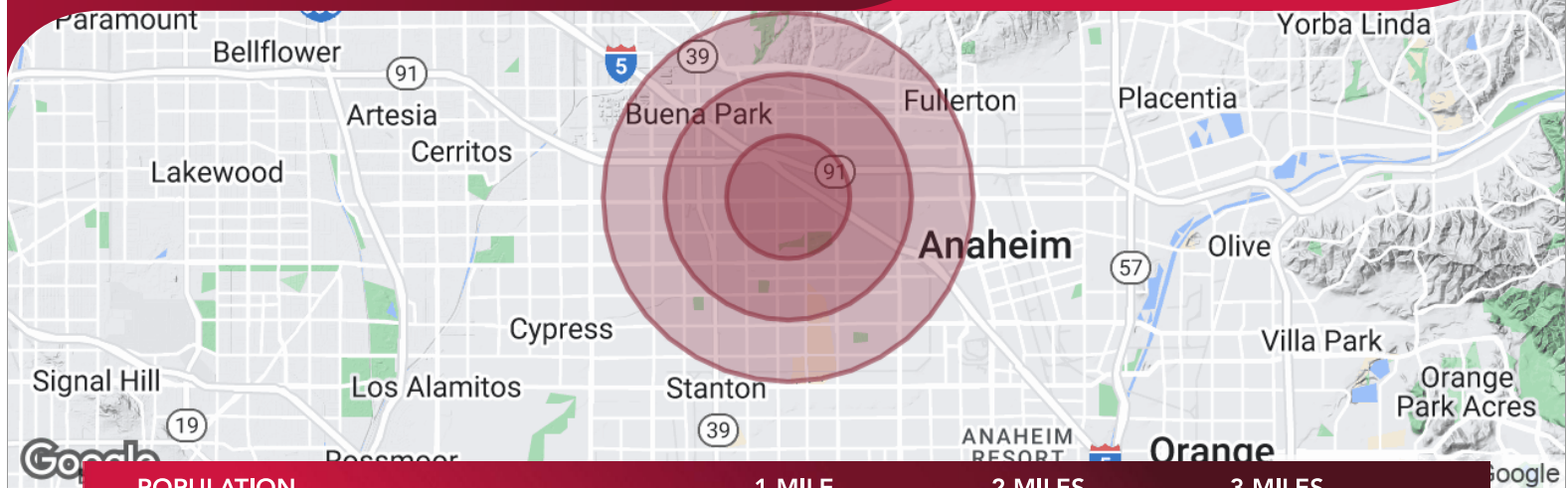

POPULATION	1 MILE	2 MILES	3 MILES
Total population	27,155	116,833	264,328
Median age	33.3	32.5	32.9
Median age (Male)	32.7	31.8	31.9
Median age (Female)	33.9	33.2	34.2

HOUSEHOLDS & INCOME	1 MILE	2 MILES	3 MILES
Total households	7,837	34,431	77,531
# of persons per HH	3.5	3.4	3.4
Average HH income	\$67,300	\$65,962	\$68,782
Average house value	\$459,098	\$467,327	\$479,612

* Demographic data derived from 2020 ACS - US Census



Jim Hawkins

PRINCIPAL

+714.564.7126

jhawkins@lee-associates.com

DRE# 00833274

1004 West Taft Avenue, Suite 150 | Orange, CA 92865 | 714.647.9100 | lee-associates.com/orange/ | DRE# 01011260



All information furnished regarding property for sale, rental or financing is from sources deemed reliable, but no warranty or representation is made to the accuracy thereof and same is submitted to errors, omissions, change of price, rental or other conditions prior to sale, lease or financing or withdrawal without notice. No liability of any kind is to be imposed on the broker herein.