

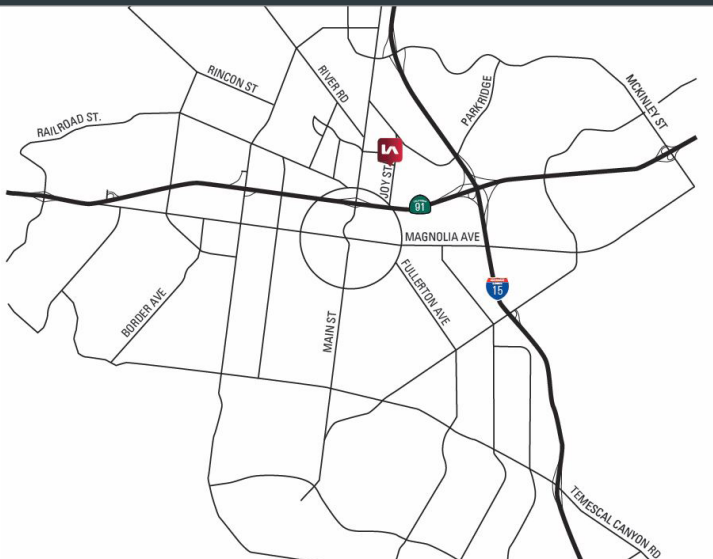

PRINCELAND COURT

CORONA, CALIFORNIA

1,050 - 9,950 SF
MULTI-TENANT INDUSTRIAL PARK



PROPERTY FEATURES:

- » Part of a master planned project
- » Great location with easy freeway access to both the 91 and 15 freeways
- » Walking distance to the Corona Metro-Link Station
- » Abundant retail amenities adjacent to the property
- » Fire sprinklers
- » 14' clear height

CONTACT US

CHRIS COYTE
Lee & Associates - Ontario
909.373.2935
ccoyle@lee-assoc.com
DRE # 01017328

JOHN MARTIN
Lee & Associates - Ontario
949.373.2941
jmartin@lee-assoc.com
DRE # 01346629



PRINCLAND COURT

CORONA, CALIFORNIA

CURRENT AVAILABILITY

ADDRESS	AVAILABLE SF	OFFICE SF	PRICE PSF*	DATE AVAIL.
410 Princland Court, Suite 3	1,560	500	\$1.60 MG	Now

*All suites have a \$0.08 CAM fee in addition to base rent.

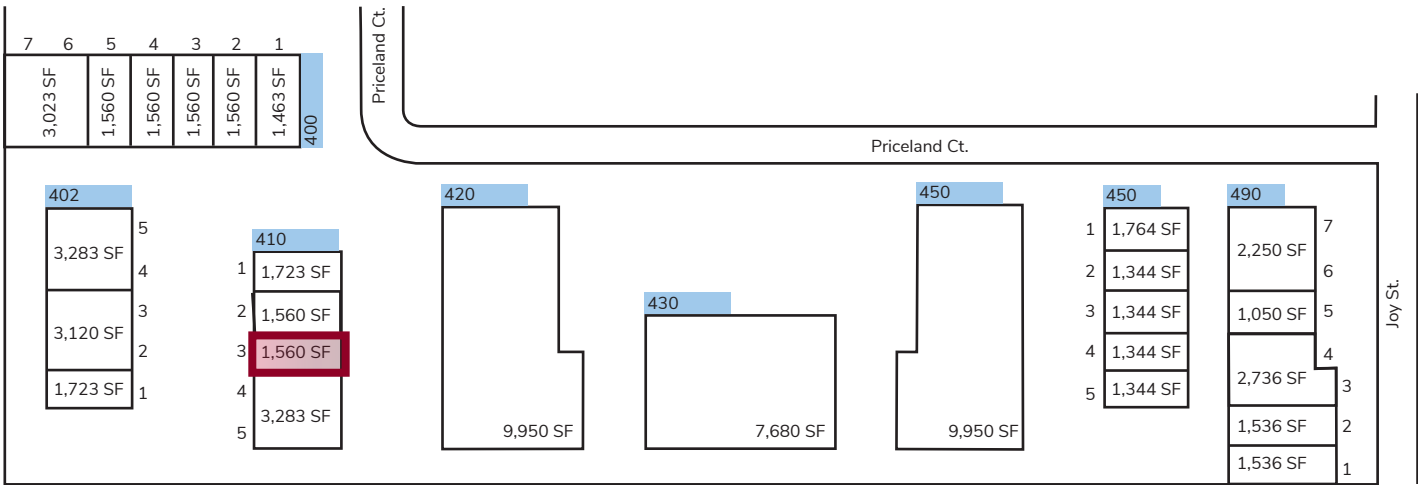

CONTACT US

CHRIS COYTE
 Lee & Associates - Ontario
 909.373.2935
 ccoyte@lee-assoc.com
 DRE # 01017328

JOHN MARTIN
 Lee & Associates - Ontario
 949.373.2941
 jmartin@lee-assoc.com
 DRE # 01346629



DISCLAIMER: The information contained herein has been obtained from the property owner or other third party and is provided to you without verification as to accuracy. We (Lee & Associates, its brokers, employees, agents, principals, officers, directors and affiliates) make no warranty or representation regarding the information, property, or transaction. You and your attorneys, advisors and consultants should conduct your own investigation of the property and transaction.

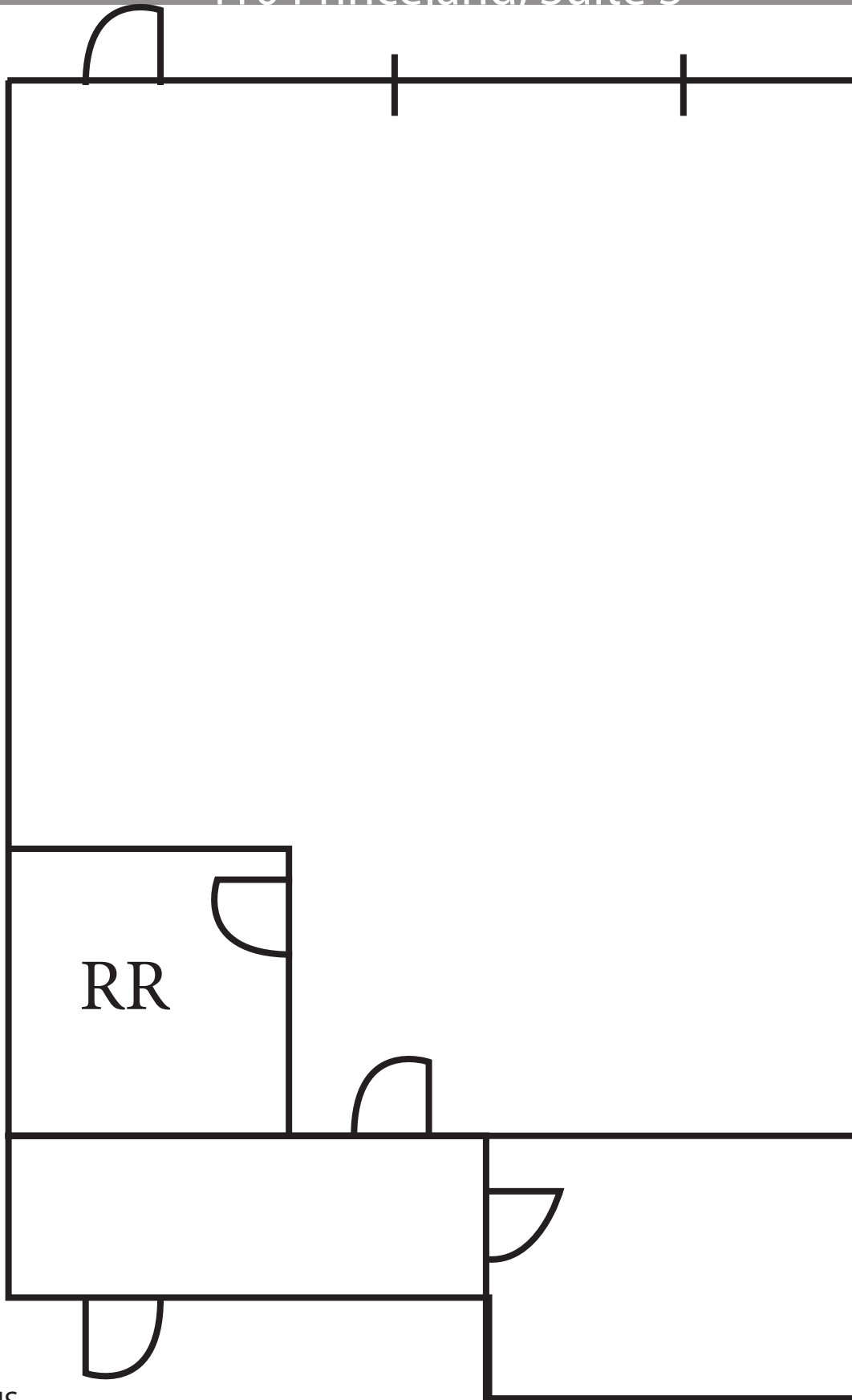

CONTACT US

CHRIS COYTE

Lee & Associates - Ontario

909.373.2935

ccoyte@lee-assoc.com

DRE # 01017328

JOHN MARTIN

Lee & Associates - Ontario

949.373.2941

jmartin@lee-assoc.com

DRE # 01346629



DISCLAIMER: The information contained herein has been obtained from the property owner or other third party and is provided to you without verification as to accuracy. We (Lee & Associates, its brokers, employees, agents, principals, officers, directors and affiliates) make no warranty or representation regarding the information, property, or transaction. You and your attorneys, advisors and consultants should conduct your own investigation of the property and transaction.