

FOR LEASE

18TH STREET / WHITTIER INDUSTRIAL PARK

1001-1025 W. 18th Street, Costa Mesa



PROPERTY HIGHLIGHTS

- Prime West Cost Mesa Location
- Close Proximity to Newport Beach
- Well Maintained Business Park
- Ground Level Loading
- Office/Warehouse Units Ideal for Storage, Light Manufacturing and Warehousing
- Excellent Access to Pacific Coast Highway, 55/405 Freeways and 73 Tollroads



LOREN CARGILE
Vice President | Partner
424.329.7515
Lic. #01431329
lcargile@voitco.com

Voit
REAL ESTATE SERVICES

CARGILE
COMMERCIAL GROUP

FOR LEASE

18TH STREET / WHITTIER INDUSTRIAL PARK

1001-1025 W. 18th Street, Costa Mesa

1007 W 18th St., Costa Mesa

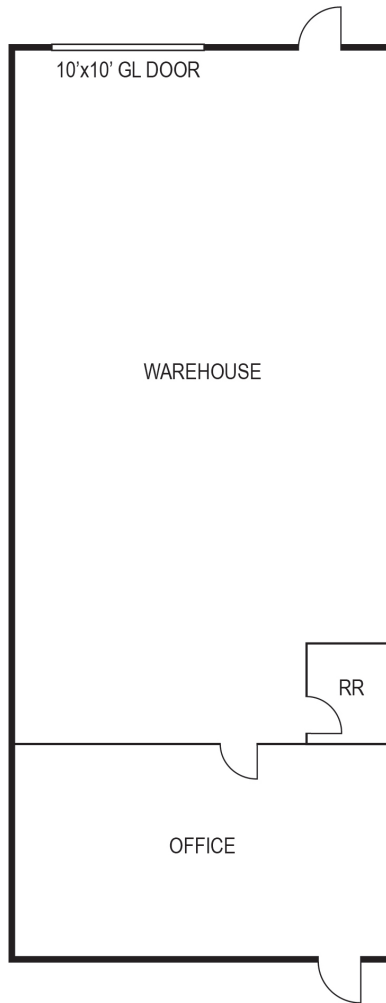

**Floor plans not to scale, verify layout*

Address	Total Size	Office Size	Asking Rate	Monthly Rent	Comments
1007 W 18th St.	± 1,300	± 250 SF	\$2.25/SF	\$2,925.00	Available Now, Front Office, Restroom, Warehouse, Roll Up Door, Renovated Unit

LOREN CARGILE
Vice President | Partner
424.329.7515
Lic. #01431329
lcargile@voitco.com

Voit
REAL ESTATE SERVICES

