

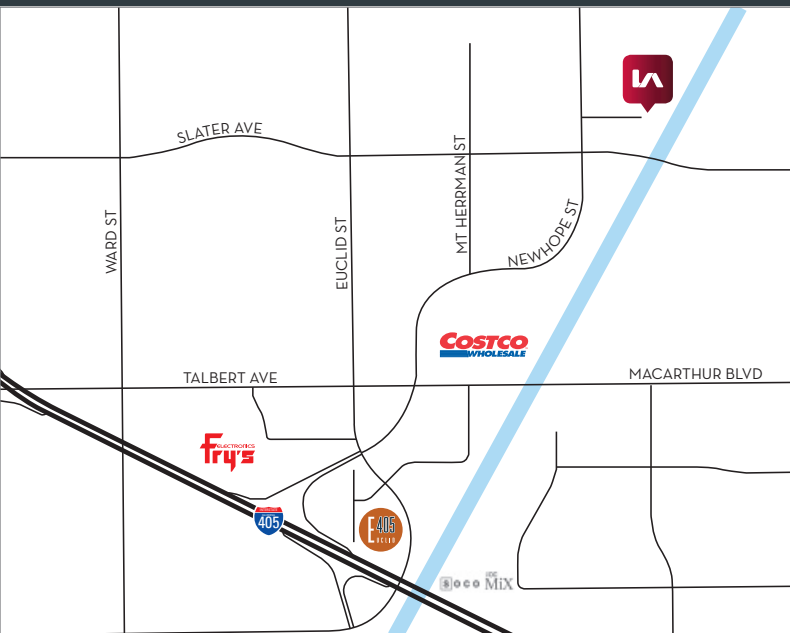

MARTENS RIVER COMPLEX

11661 MARTENS RIVER CIRCLE, FOUNTAIN VALLEY, CALIFORNIA

1,980 SF AVAILABLE
MULTI-TENANT INDUSTRIAL PARK



PROPERTY FEATURES:

- » 21,780 SF multi-tenant industrial building
- » 16 units
- » Office / warehouse
- » Street level warehouse
- » Front and rear access to units
- » Drive around building
- » Semi-truck access

For more information, please contact:

JOHN MARTIN
office: 949.724.4701
john@lee-associates.com
DRE #: 01346629



LEE & ASSOCIATES® - NEWPORT BEACH | Corporate ID #01197433
100 Bayview Circle, Suite 600, Newport Beach, California 92660
☎ 949.724.1000 | 📠 949.862.9048 | www.lee-associates.com



MARTENS RIVER COMPLEX

11661 MARTENS RIVER CIRCLE, FOUNTAIN VALLEY, CALIFORNIA

CURRENT AVAILABILITY			
ADDRESS	AVAILABLE SF	PRICE PSF*	DATE AVAIL.
11661 Martens River Cirle, Unit A	1,980	\$1.15 G	Now

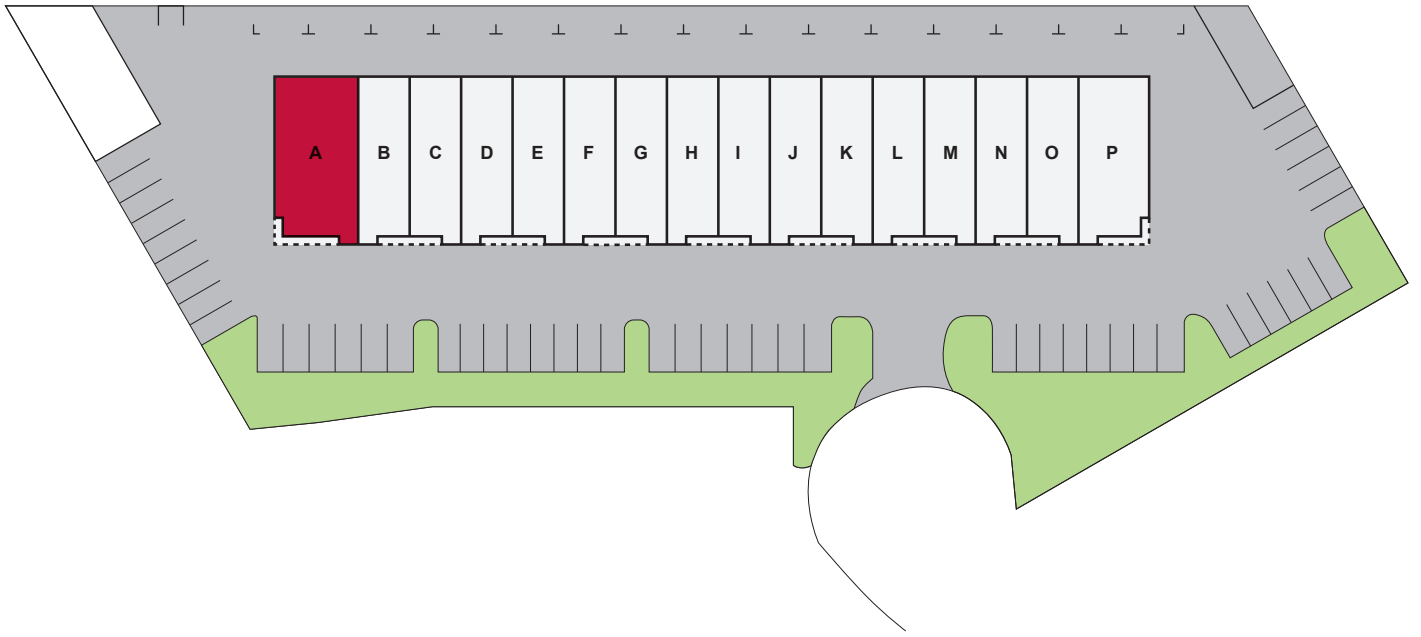

For more information, please contact:

JOHN MARTIN

office: 949.724.4701

john@lee-associates.com

DRE #: 01346629



LEE & ASSOCIATES® - NEWPORT BEACH | Corporate ID #01197433
100 Bayview Circle, Suite 600, Newport Beach, California 92660
☎ 949.724.1000 | 📠 949.862.9048 | www.lee-associates.com

DISCLAIMER: The information contained herein has been obtained from the property owner or other third party and is provided to you without verification as to accuracy. We (Lee & Associates, its brokers, employees, agents, principals, officers, directors and affiliates) make no warranty or representation regarding the information, property, or transaction. You and your attorneys, advisors and consultants should conduct your own investigation of the property and transaction.



MARTENS RIVER COMPLEX

11661 MARTENS RIVER CIRCLE, UNIT A, FOUNTAIN VALLEY, CALIFORNIA

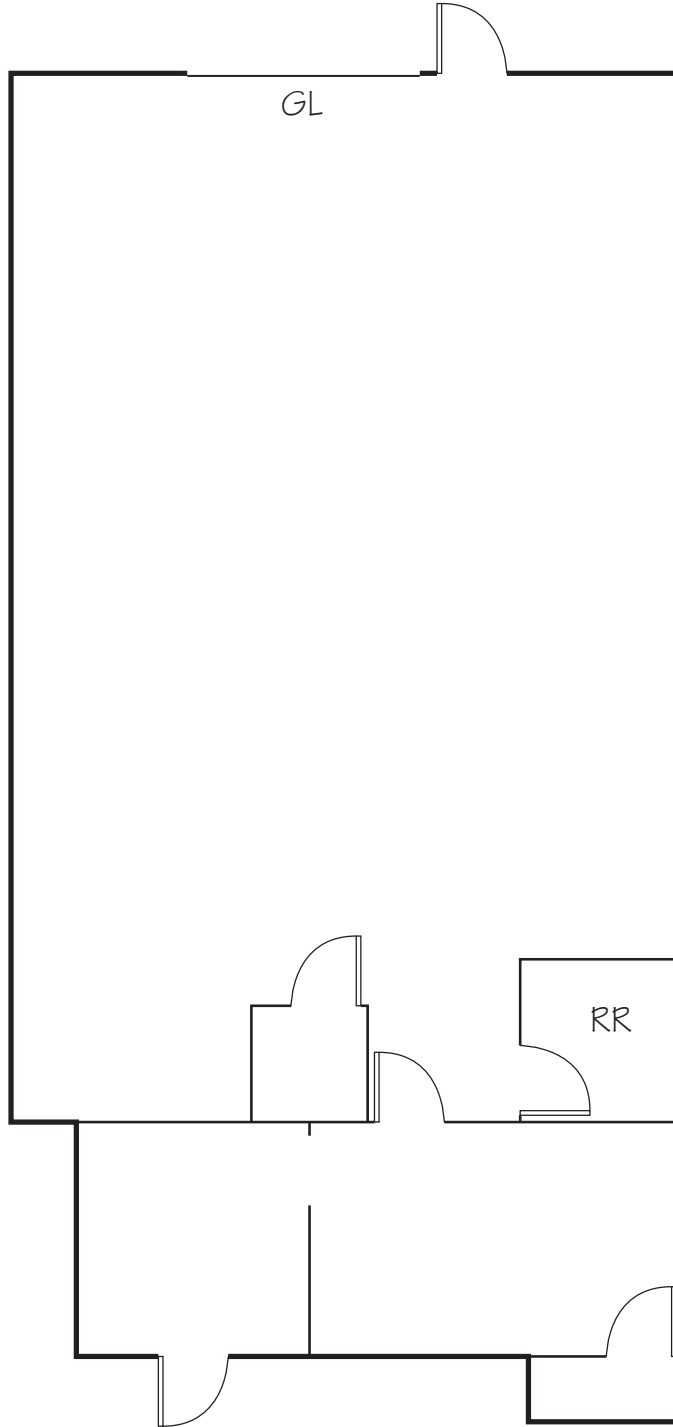

Not to scale.
Not as built.

For more information, please contact:

JOHN MARTIN

office: 949.724.4701

john@lee-associates.com

DRE #: 01346629



LEE & ASSOCIATES® - NEWPORT BEACH | Corporate ID #01197433
100 Bayview Circle, Suite 600, Newport Beach, California 92660
☎ 949.724.1000 | 📠 949.862.9048 | www.lee-associates.com

DISCLAIMER: The information contained herein has been obtained from the property owner or other third party and is provided to you without verification as to accuracy. We (Lee & Associates, its brokers, employees, agents, principals, officers, directors and affiliates) make no warranty or representation regarding the information, property, or transaction. You and your attorneys, advisors and consultants should conduct your own investigation of the property and transaction.