



OFFICE SPACE FOR LEASE

1200 QUAIL STREET
Newport Beach, California

for more information, visit www.lee-irvine.com



Exclusively listed by:

Dave Smith
Senior Vice President
CalBRE 01195186
949.790.3134
dsmith@leeirvine.com

Matt Fryer
Senior Vice President
CalBRE 01333079
949.790.3122
mfryer@leeirvine.com

Lee & Associates, Inc. - Irvine
9838 Research Drive
Irvine, California 92618

PROPERTY FEATURES

- Prime Newport Beach location
- Quality garden office building
- COMMON AREA CONFERENCE ROOM AVAILABLE BY RESERVATION AT NO CHARGE
- Extensive glass line
- Free surface parking and limited covered parking available at monthly charge
- Close to numerous retail amenities
- Minutes to John Wayne Airport
- Immediate access to the 405, 55 and 73 Freeways

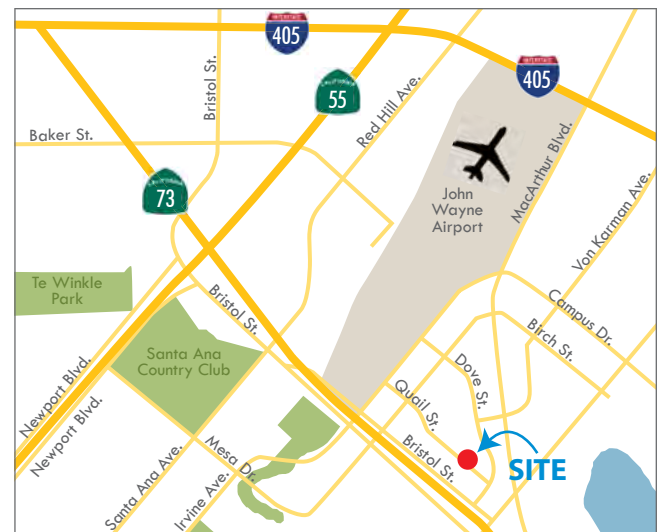



OFFICE SPACE FOR LEASE

1200 QUAIL STREET

Newport Beach, California



AVAILABILITY

Suite	Sq. Ft.	Lease Rate	Description
255	1,005	\$2.50 FSG	Three (3) offices and open area.
260	703	\$2.50 FSG	Two (2) offices and open area.

Exclusively listed by:

Dave Smith
 Senior Vice President
 CalBRE 01195186
 949.790.3134
 dsmith@leeirvine.com

Matt Fryer
 Senior Vice President
 CalBRE 01333079
 949.790.3122
 mfryer@leeirvine.com

Lee & Associates, Inc. - Irvine
 9838 Research Drive
 Irvine, California 92618



COMMERCIAL REAL ESTATE SERVICES

No warranty or representation is made to the accuracy of the foregoing information. Terms of sale or lease and availability are subject to change or withdrawal without notice.



OFFICE SPACE FOR LEASE

1200 QUAIL STREET
Newport Beach, California



SUITE 255 - 1,005 SQ. FT.

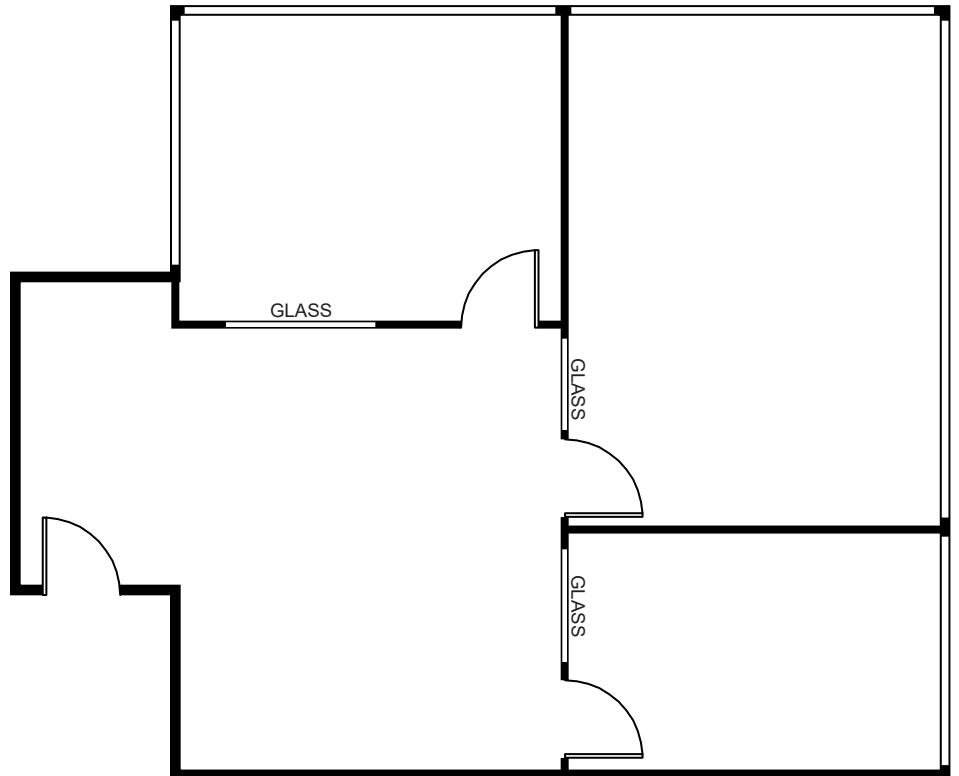

Exclusively listed by:

Dave Smith

Senior Vice President
CalBRE 01195186
949.790.3134
dsmith@leeirvine.com

Matt Fryer

Senior Vice President
CalBRE 01333079
949.790.3122
mfryer@leeirvine.com

Lee & Associates, Inc. - Irvine
9838 Research Drive
Irvine, California 92618



COMMERCIAL REAL ESTATE SERVICES

No warranty or representation is made to the accuracy of the foregoing information. Terms of sale or lease and availability are subject to change or withdrawal without notice.



OFFICE SPACE FOR LEASE

1200 QUAIL STREET
Newport Beach, California



SUITE 260 - 703 SQ. FT.

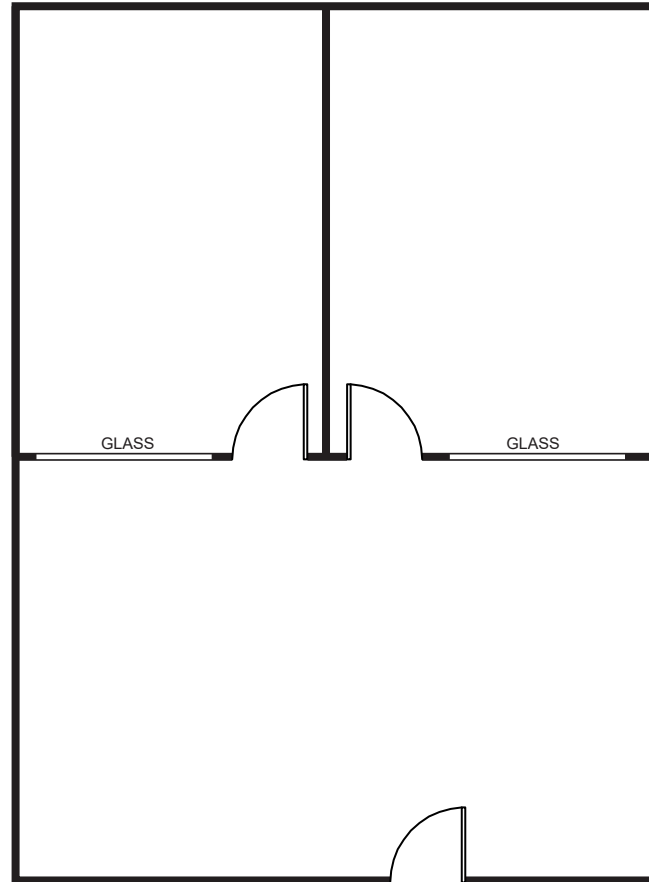

Exclusively listed by:

Dave Smith

Senior Vice President
CalBRE 01195186
949.790.3134
dsmith@leeirvine.com

Matt Fryer

Senior Vice President
CalBRE 01333079
949.790.3122
mfryer@leeirvine.com

Lee & Associates, Inc. - Irvine
9838 Research Drive
Irvine, California 92618

