

# NOW LEASING



## EUREKA PLACE

4811 Eureka Avenue, Yorba Linda, CA 92886

### Two Story Multi-Tenant Office Building

- Sizes 65 - 1650 s.f. units.
- Affluent neighborhood.
- Offices and some executive suites on the second floor.
- Some retail uses allowed.
- Elevator, 24/7 security monitoring, and Spectrum WiFi.
- Easy access to Imperial Highway, 57 & 91 Freeways
- Yorba Linda Post Office is across the street at 4770 Eureka Ave.

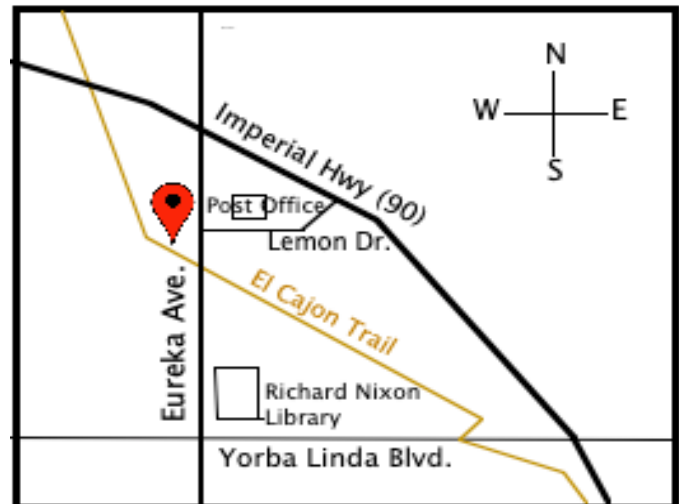

S & D Associates  
1020 N. Batavia St, Ste B  
Orange, CA 92867  
email: [sdassociates@sbcglobal.net](mailto:sdassociates@sbcglobal.net)  
[www.sdassociatesproperties.com](http://www.sdassociatesproperties.com)

For further information  
contact Salila Limolansuksakul  
(714) 997-7956 ext. 102  
fax (714) 997-4930

# EUREKA PLACE "EXHIBIT A" SITE PLAN

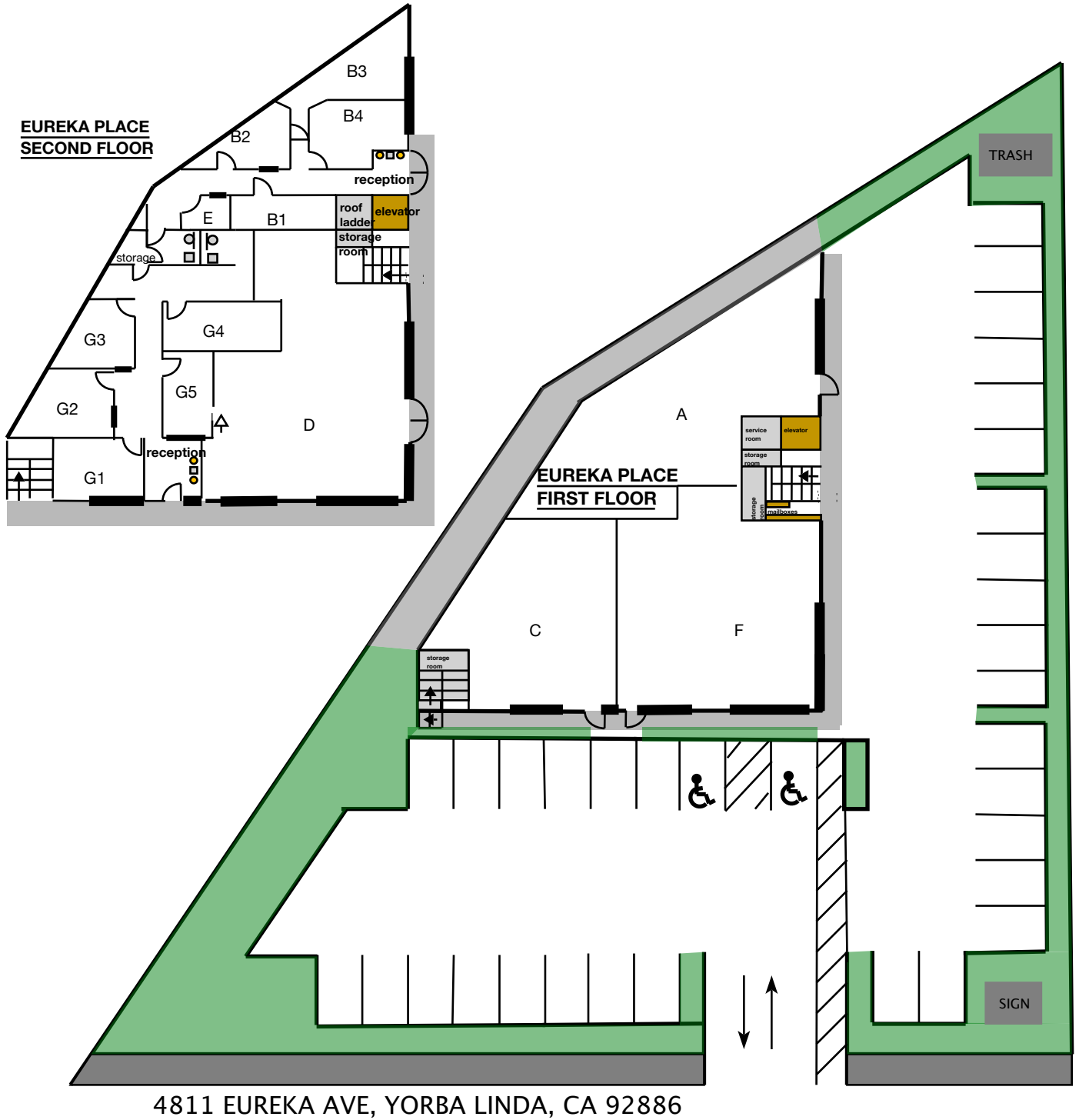

The sign plan isn't drawn to scale. Its accuracy is not guaranteed. Last updated 1/12/24