



SUBJECT

MONARCH STREET

For Lease

19,989 SF

INSTITUTIONALLY MANAGED | FLEXIBILITY TO GROW IN A PORTFOLIO | DELIVERING UNPRECEDENTED CUSTOMER SERVICE

12752 MONARCH STREET, GARDEN GROVE, CA

ORANGE COUNTY

FOR INFORMATION, CONTACT:

JEFF READ
949.608.2029
CA RE Lic. #01040265

GREG OSBORNE
949.608.2076
CA RE Lic. #01310074

**Major Renovations
in Process:**

- Installation of an Interior Truckwell
- Upgrading Sprinkler System to .60/3,000 GPM



Excellent West Orange County Manufacturing/Distribution Facility

- Excellent West Orange County
- Manufacturing/Distribution Facility
- Approximately 1,392 SF of Renovated Office Area
- 21' Minimum Warehouse Ceiling Clearance
- Fully Fire Sprinklered: .60/3,000 GPM
- Two (2) Ground Level Loading Doors
- One (1) Interior Truckwell
- Approximate 1.0:1,000 S.F. Parking Ratio
- End Cap Unit
- Power Capacity: 200 Amps, 120/240 V, 3 Phase
- Excellent Garden Grove Location with immediate access to the Garden Grove (22) Freeway, providing convenient access throughout Orange County and easy access to Los Angeles County



For Lease

12752 MONARCH STREET, GARDEN GROVE, CA

19,989 SF

ORANGE COUNTY

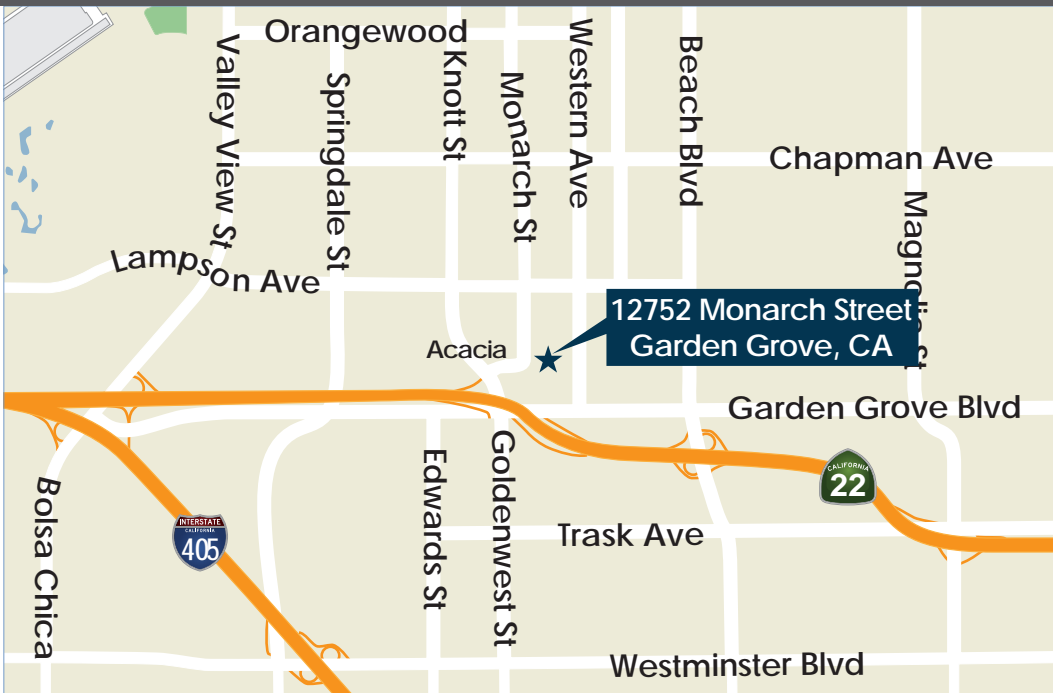

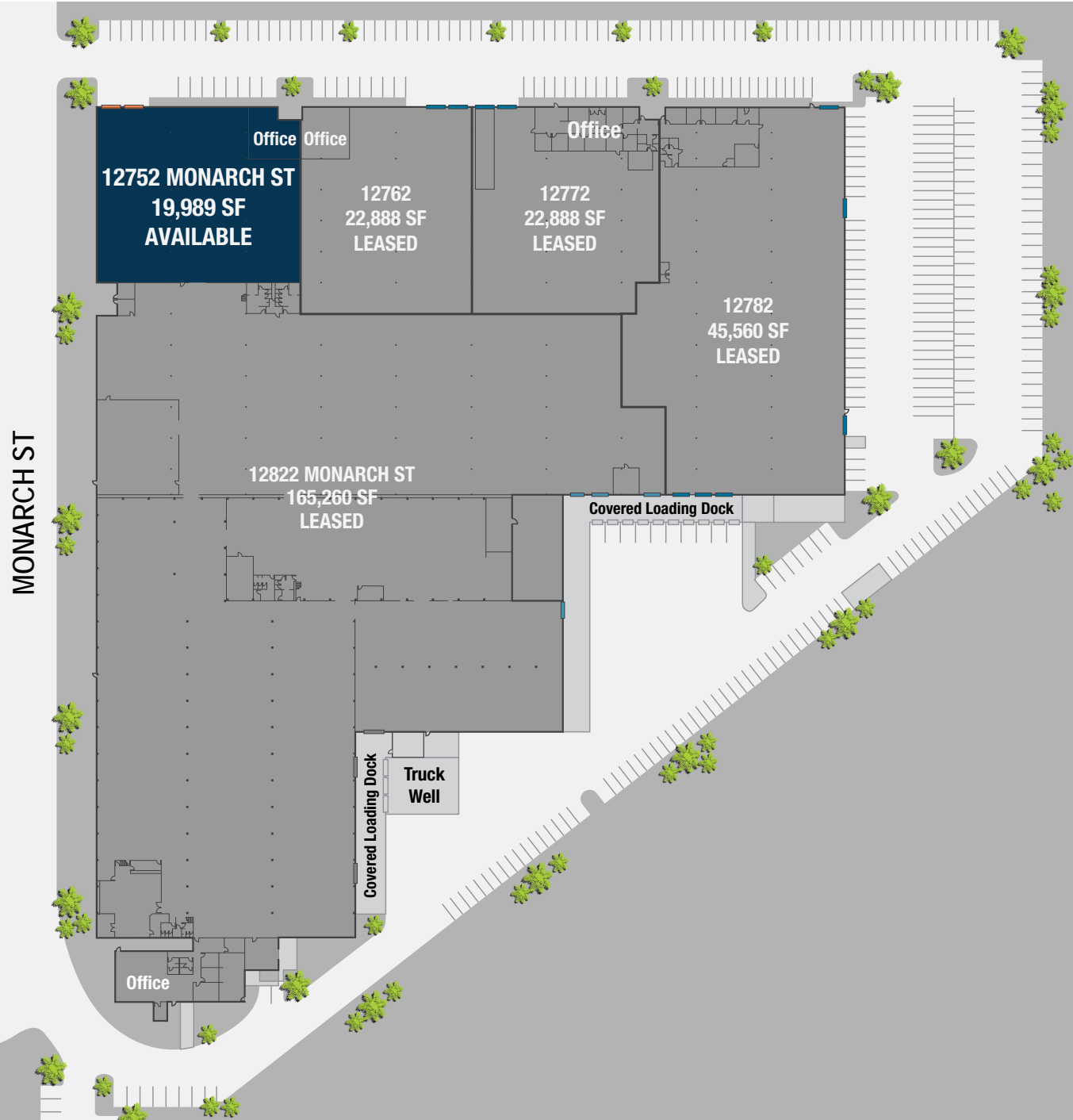

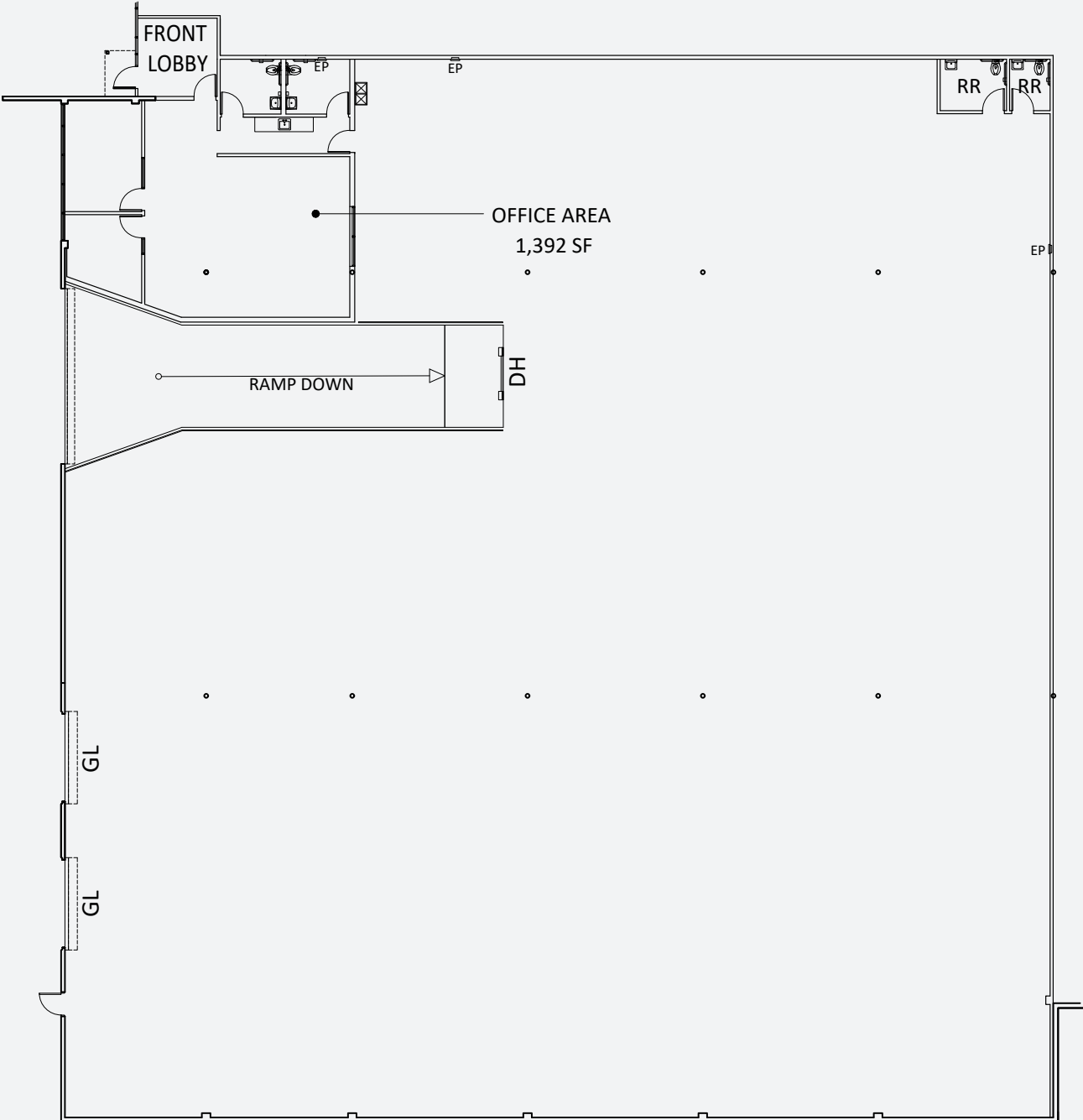

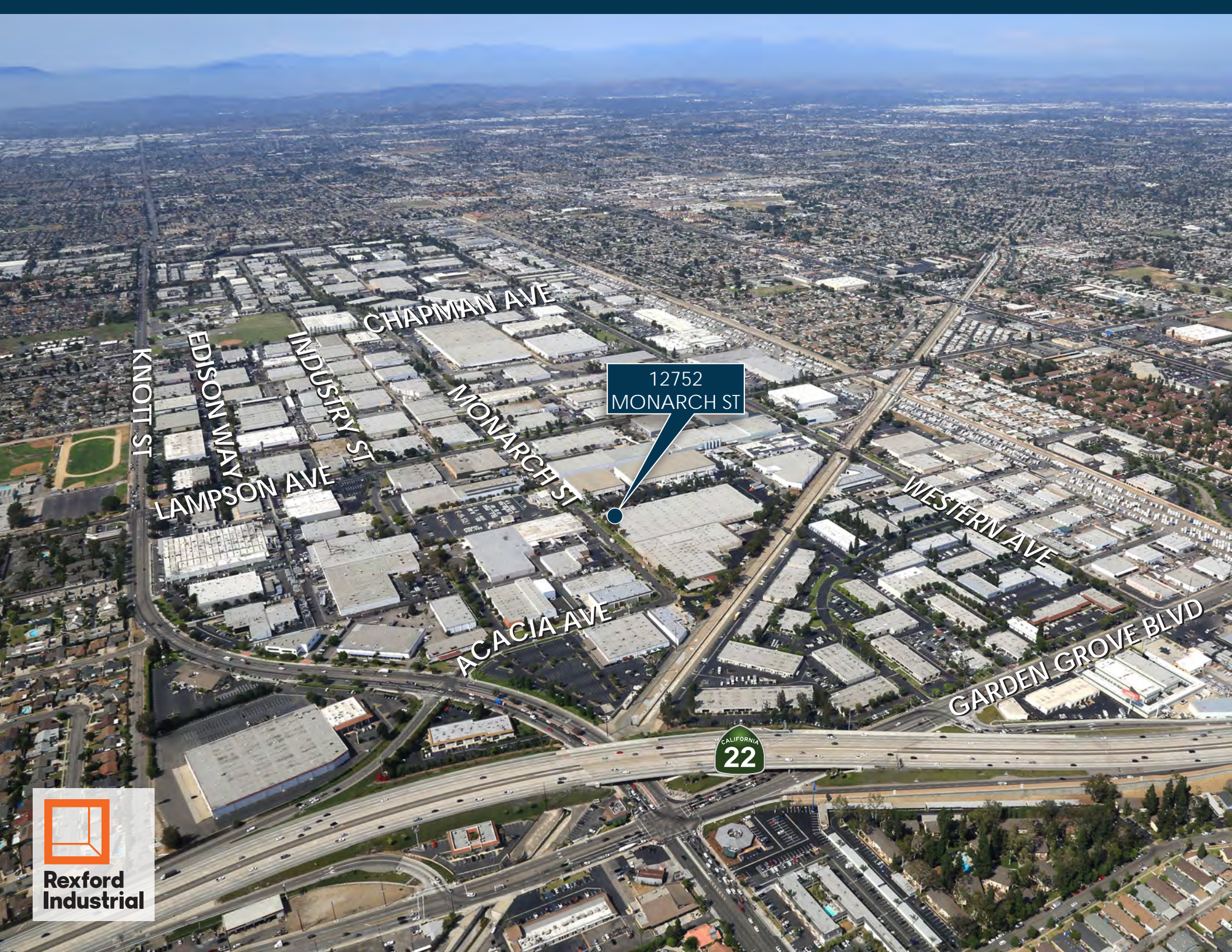

12752
MONARCH ST

KNOTT ST

EDISON WAY

LAMPSON AVE

INDUSTRY ST

CHAPMAN AVE

MONARCH ST

ACACIA AVE

WESTERN AVE

GARDEN GROVE BLVD

CALIFORNIA
22

