

**15529 Blackburn Avenue**  
**Norwalk, California**

**FOR LEASE**  
**10,060 Square Feet**

**MAJOR OFFICE & BUILDING UPGRADES JUST COMPLETED**



New  
Exterior  
Storefront



New  
Roof  
2018



Upgraded  
Warehouse  
Lighting



New Interior  
&  
Exterior Paint

**FEATURES:**

- **Norwalk Industrial Park**
- Part of a Larger High Image Industrial Building
- Four (4) Ground Level Loading Doors
- $\pm$  1,500 Sq.Ft. of HVAC Office Area
- Ample Parking
- **End Cap Unit**
- $\pm$  16' Minimum Warehouse Ceiling Clearance
- Professionally Managed Business Park
- Ideal Mid-Cities Location
- Excellent Access to the Santa Ana (5), Riverside (91) & San Gabriel (605) Freeways

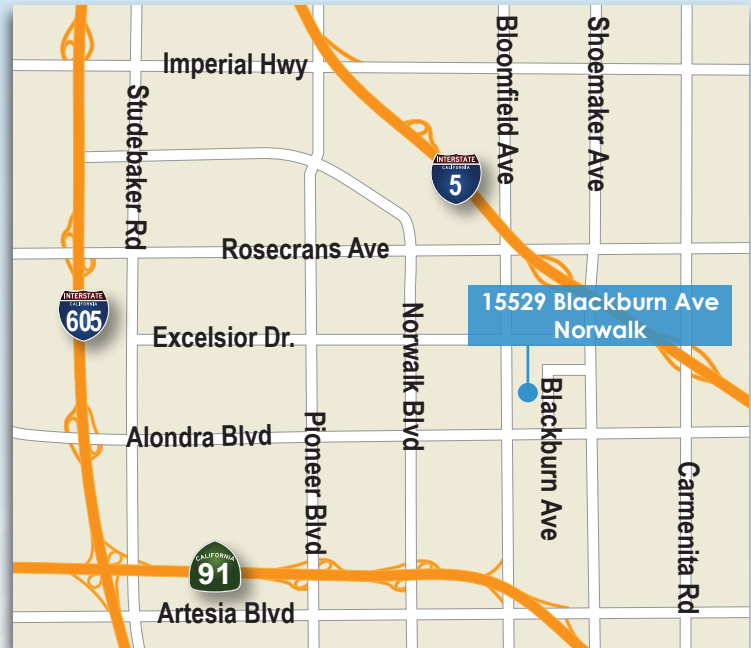

For further information, please contact:

**Jeff Read** 949.608.2029 jread@ngkf.com CA RE Lic. #01040265

**Greg Osborne** 949.608.2076 gosborne@ngkf.com CA RE Lic. #01310074

4675 MacArthur Court, Suite 1600, Newport Beach, CA 92660 | 949.608.2000 Corporate CA RE Lic. #01355491



**BUILDING  
SITE PLAN**

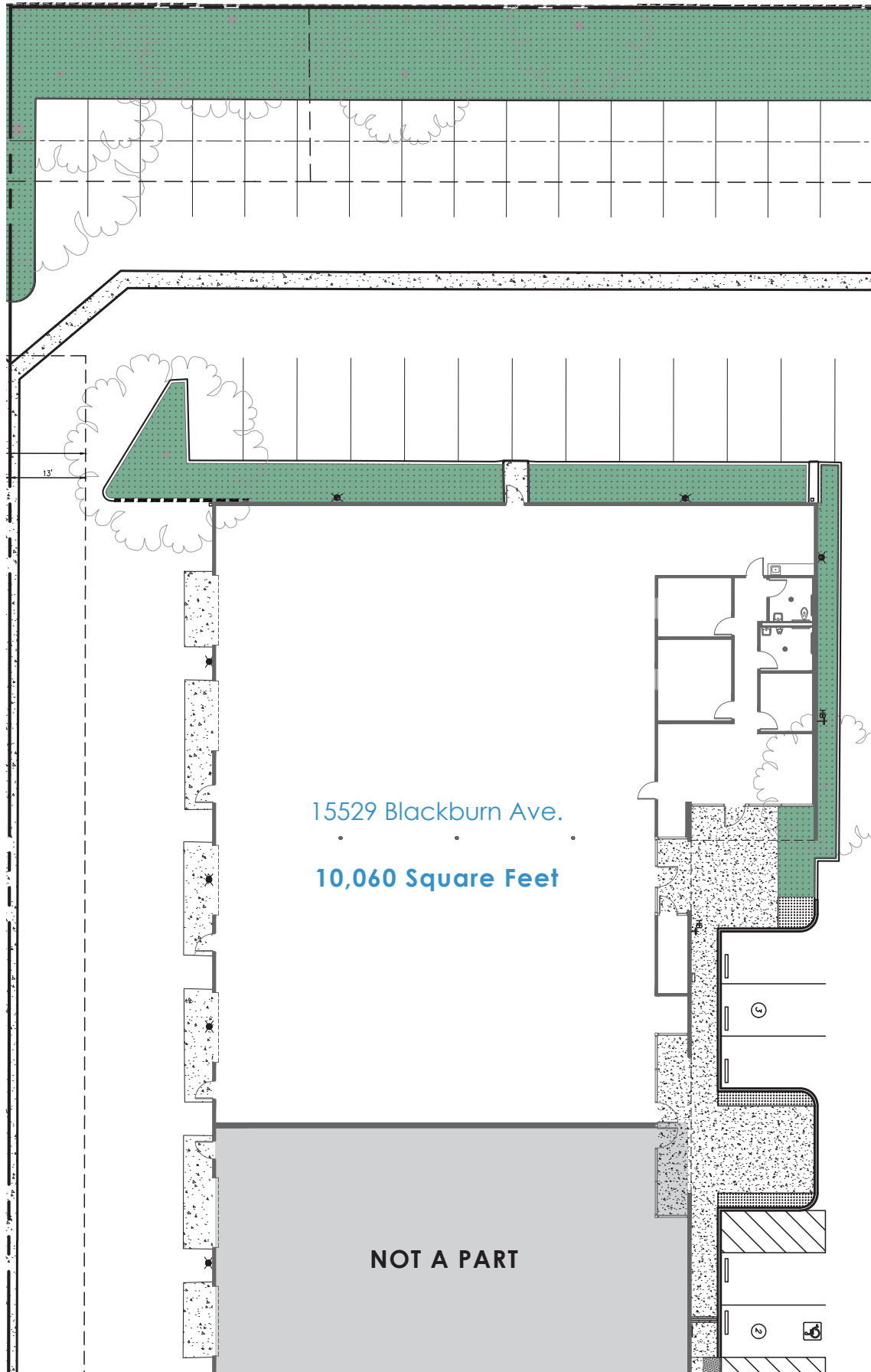

# PROJECT SITE PLAN





## WAREHOUSE



## OFFICE

