

15523 Blackburn Avenue
Norwalk, California

FOR LEASE
4,073 Square Feet



MAJOR OFFICE & BUILDING UPGRADES JUST COMPLETED



New Exterior Storefront



New Roof 2018



Upgraded Warehouse Lighting



New Interior & Exterior Paint

FEATURES:

- **Norwalk Industrial Park**
- Part of a Larger High Image Industrial Building
- Two (2) Ground Level Loading Doors
- ± 1,202 Sq.Ft. of HVAC Office Area
- Ample Parking
- **Clear Span Warehouse**
- ± 16' Minimum Warehouse Ceiling Clearance
- Professionally Managed Business Park
- Ideal Mid-Cities Location
- Excellent Access to the Santa Ana (5), Riverside (91) & San Gabriel (605) Freeways



For further information, please contact:

Jeff Read 949.608.2029 jread@ngkf.com CA RE Lic. #01040265

Greg Osborne 949.608.2076 gosborne@ngkf.com CA RE Lic. #01310074

4675 MacArthur Court, Suite 1600, Newport Beach, CA 92660 | 949.608.2000 Corporate CA RE Lic. #01355491



**BUILDING
SITE PLAN**

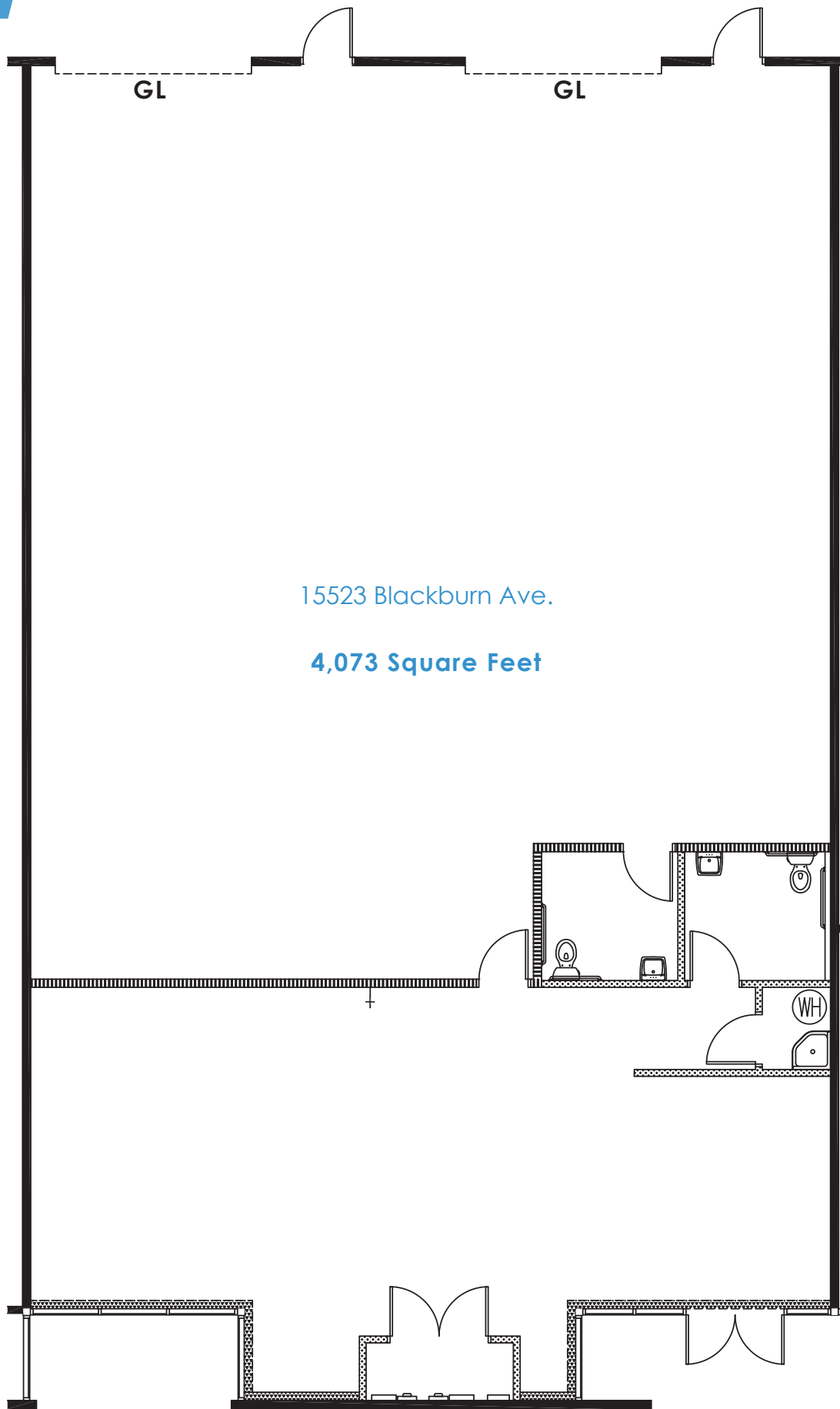

15523 Blackburn Ave.

4,073 Square Feet

PROJECT SITE PLAN

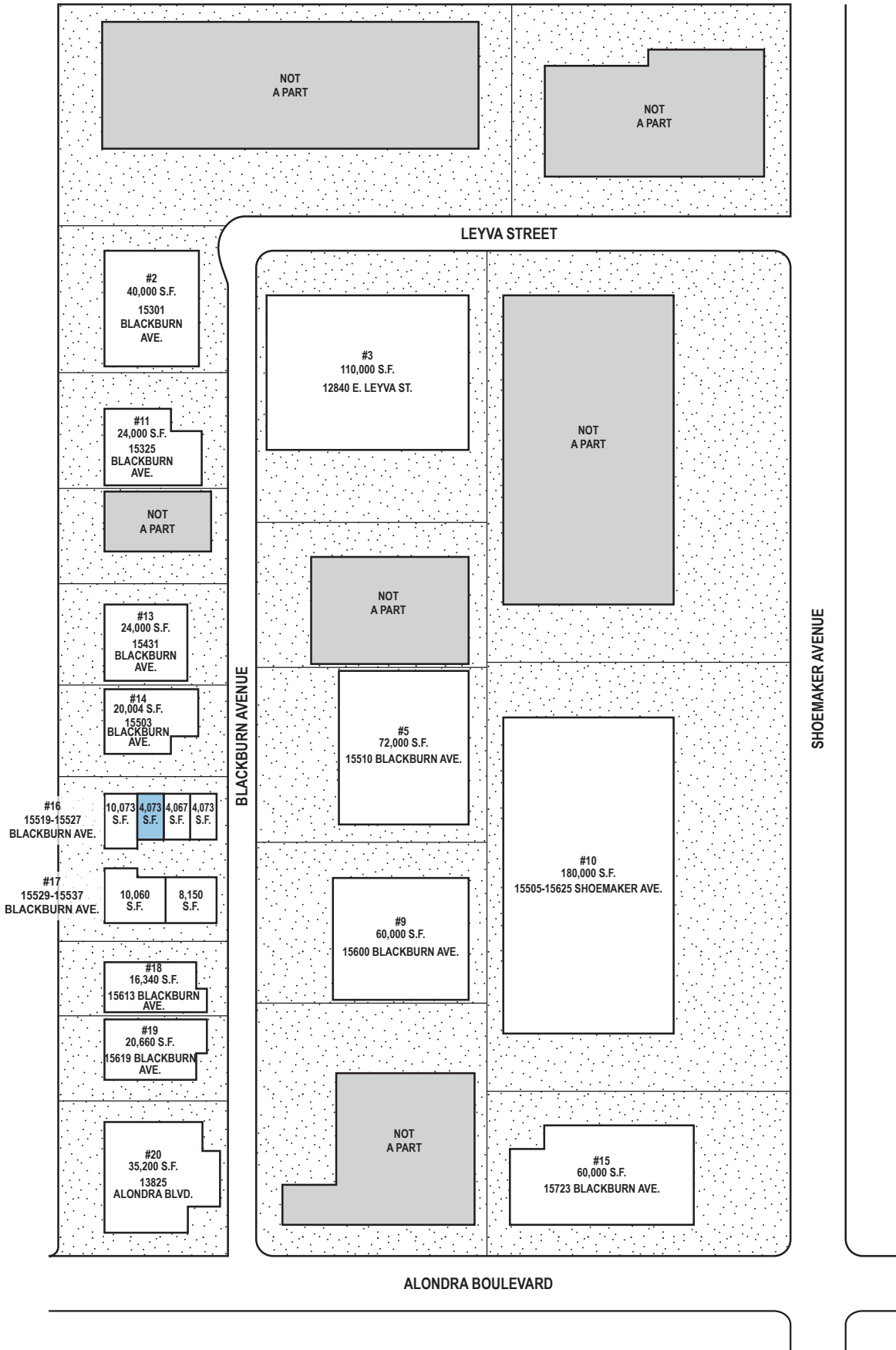

WAREHOUSE



EXTERIOR - REAR



OFFICE

