

FOR LEASE - ±14,164 SF

**Voit**

REAL ESTATE SERVICES

## High Image Industrial Building

15251 Barranca Parkway | Irvine Spectrum | CA



### Features

- Located in the Barranca Business Park, adjacent to the Irvine Transportation Center
- Approximately 3,500 square feet of 2-Story Office Space
- 3:1,000 Parking
- 22' Minimum Clear Height
- Two 10'x12' Ground Level Doors
- 400 Amp, 277/480 Volts, 3 Phase Power
- .33/3000 SF GPM Fire Sprinklers
- Immediate access to 405, 5, and 133 Freeways

For Further Information Contact:

**Trent Walker**

Executive Vice President

Lic #00964476

949.263.5342

twalker@voitco.com



FOR LEASE - ±14,164 SF

# Industrial Building

15251 Barranca Parkway | Irvine Spectrum | CA

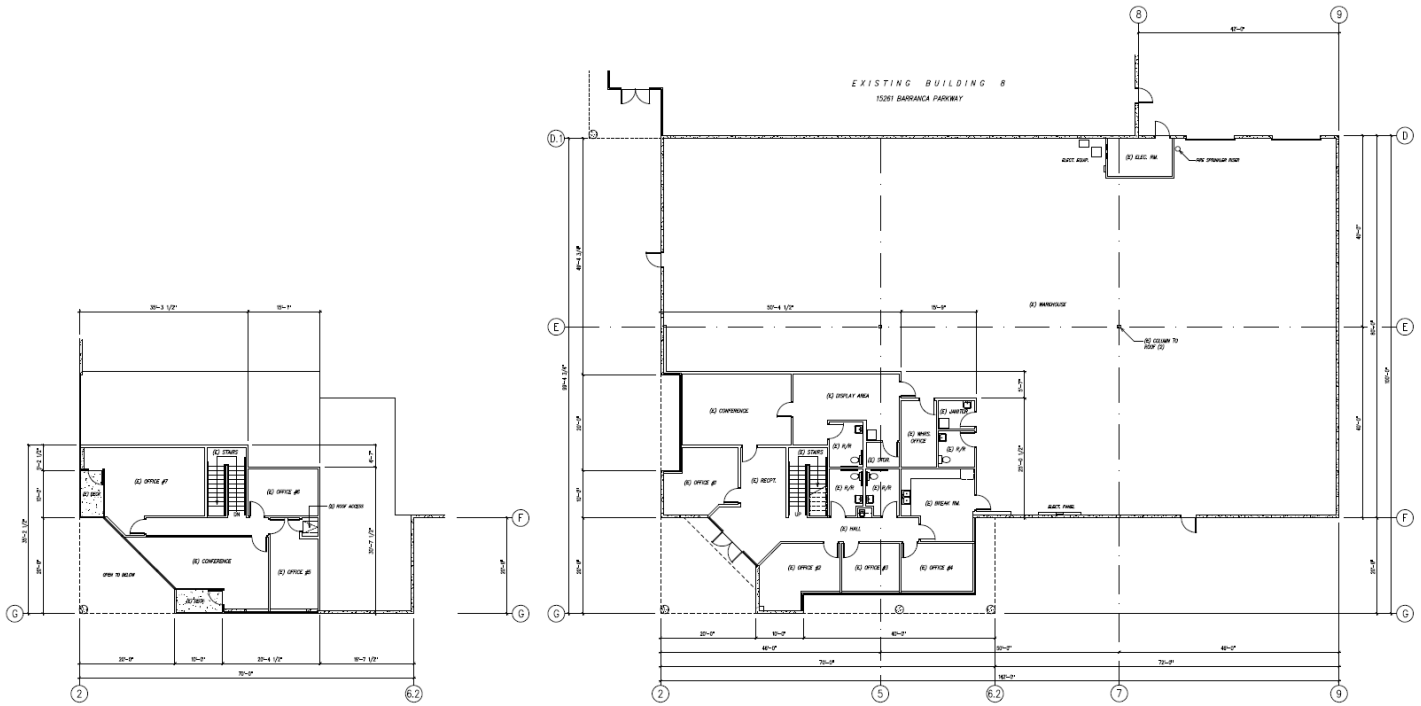

Second Floor

First Floor

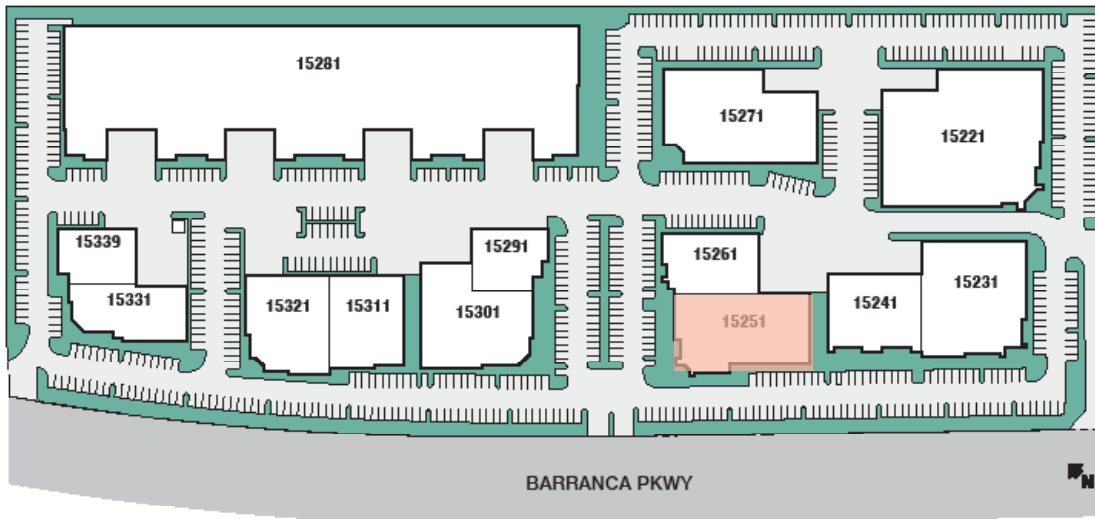

For Further Information Contact:

**Trent Walker**  
Executive Vice President  
Lic #00964476  
949.263.5342  
twalker@voitco.com

**Voit**  
REAL ESTATE SERVICES

2020 Main Street, Suite 100, Irvine, CA 92614 • 949.851.5100 • 949.261.9092 Fax • Lic #01333376 | www.voitco.com