



# 9121 PULSAR COURT CORONA, CA

# FOR LEASE

## PROPERTY FEATURES

- ± 12,724 Square Foot Industrial Building
- ± 2,274 Square Feet of Two Story Office Space
- 1 Ground Level Door (12' x 14')
- 19 Parking Stalls
- 17' Minimum Clear Height
- 800 Amps of 277/480 Volt (Verify)
- 3 Subfeeds of Electrical Stub Ups
- 3 Restrooms
- Fire Sprinklers
- Immediate Access to the  Freeway



**RYAN MOORE, SIOR**  
Senior Vice President, Partner  
909.545.8011  
RMoore@voitco.com  
Lic #01821438



**RYAN CLAYTON**  
Associate  
714.935.2319  
RClayton@voitco.com  
Lic #01997591

9121 PULSAR COURT  
CORONA, CA

± 12,724 SQ. FT.  
FOR LEASE

SITE PLAN

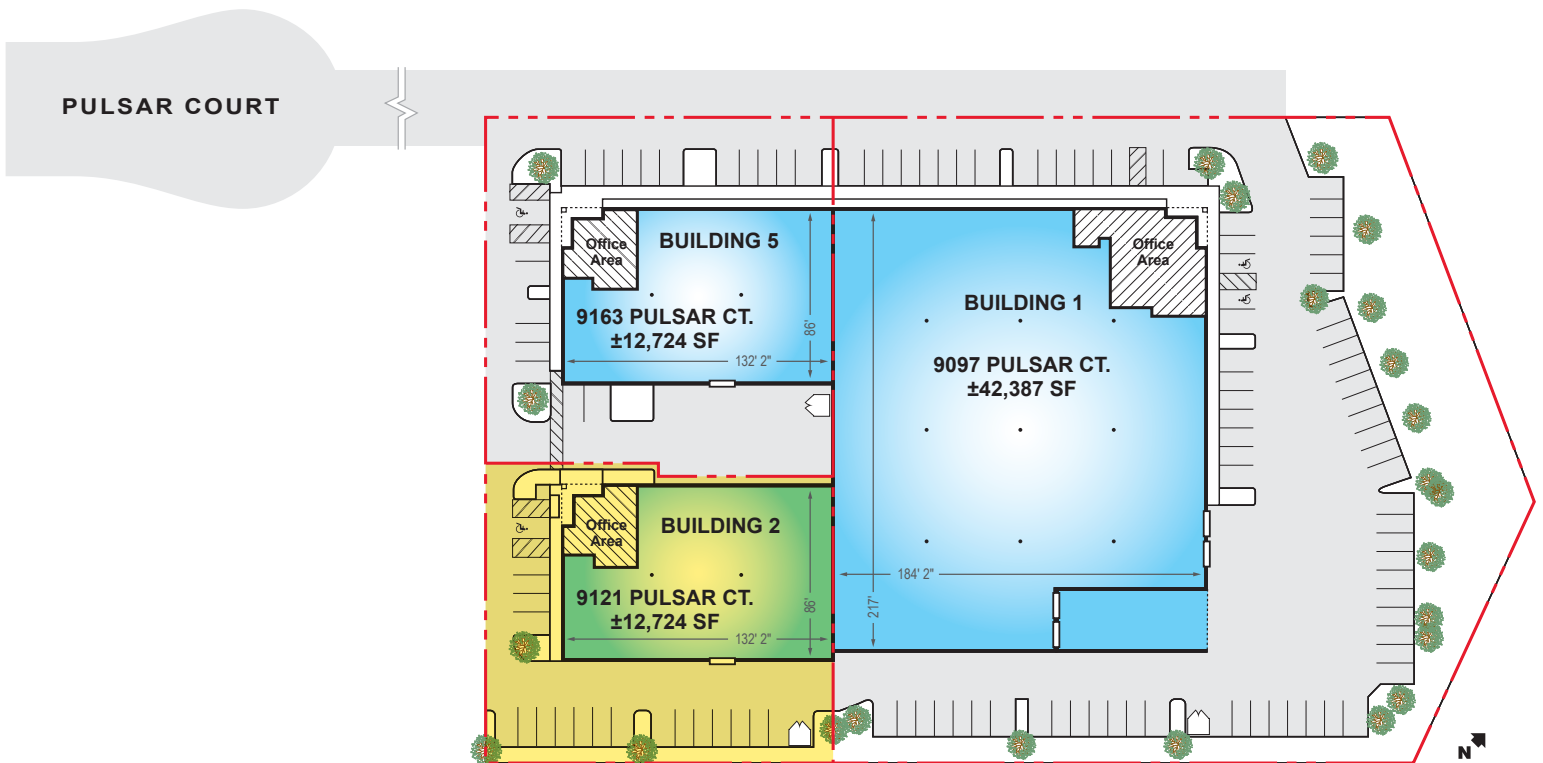

\*Site plan not to scale



**RYAN MOORE, SIOR**  
Senior Vice President, Partner  
909.545.8011  
RMoore@voitco.com  
Lic #01821438



**RYAN CLAYTON**  
Associate  
714.935.2319  
RClayton@voitco.com  
Lic #01997591

**Voit**

REAL ESTATE SERVICES

2400 E. Katella Avenue  
Suite 750  
Anaheim, CA 92806  
Lic #01991785

[www.VoitCo.com](http://www.VoitCo.com)

9121 PULSAR COURT  
CORONA, CA

± 12,724 SQ. FT.  
FOR LEASE

FLOOR PLAN

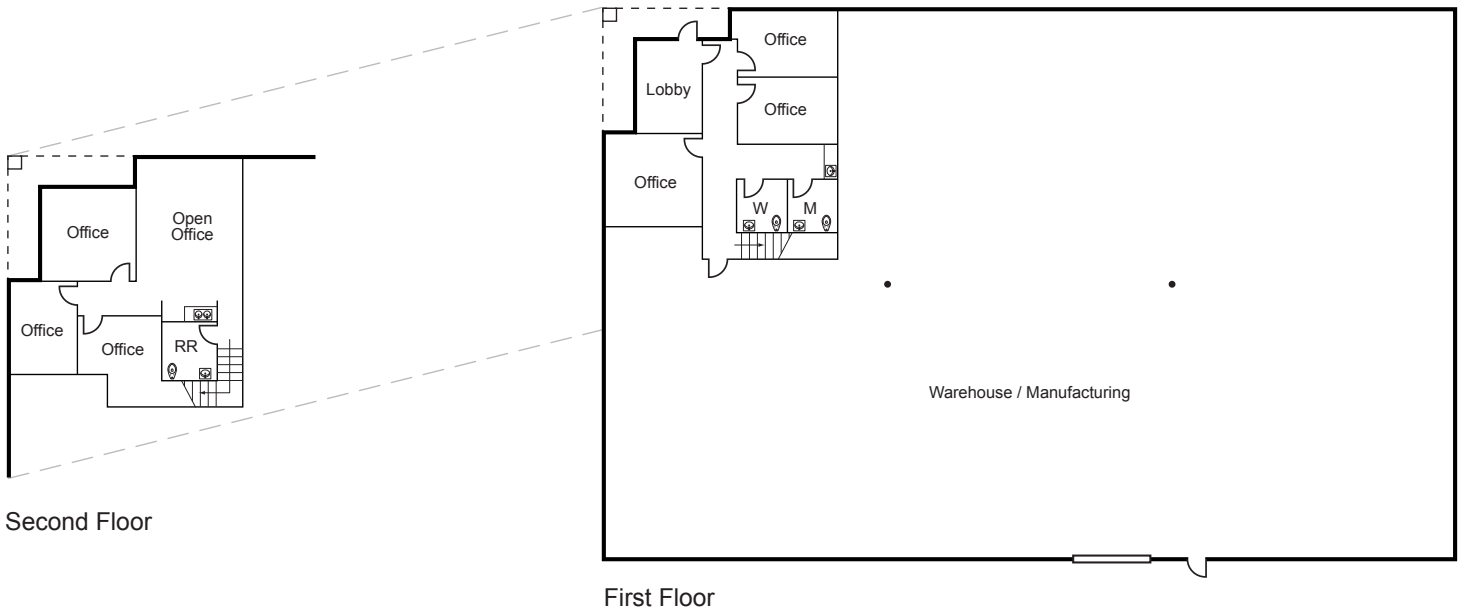

\*Floorplan not to scale



**RYAN MOORE, SIOR**  
Senior Vice President, Partner  
909.545.8011  
RMoore@voitco.com  
Lic #01821438



**RYAN CLAYTON**  
Associate  
714.935.2319  
RClayton@voitco.com  
Lic #01997591

**Voit**

REAL ESTATE SERVICES

2400 E. Katella Avenue  
Suite 750  
Anaheim, CA 92806  
Lic #01991785

[www.VoitCo.com](http://www.VoitCo.com)