

FOR LEASE

±3,466 SF AVAILABLE



160-170 Vander Street, Corona CA

LISTING HIGHLIGHTS:

- » **160 Vander St., Unit C - ±3,466 SF**
- » 2 Multi Tenant Industrial Buildings Totaling ±28,025 SF
- » Ample Parking On-Site
- » Ground Level Loading
- » Easy access to the 91, 71, & I-15 freeways

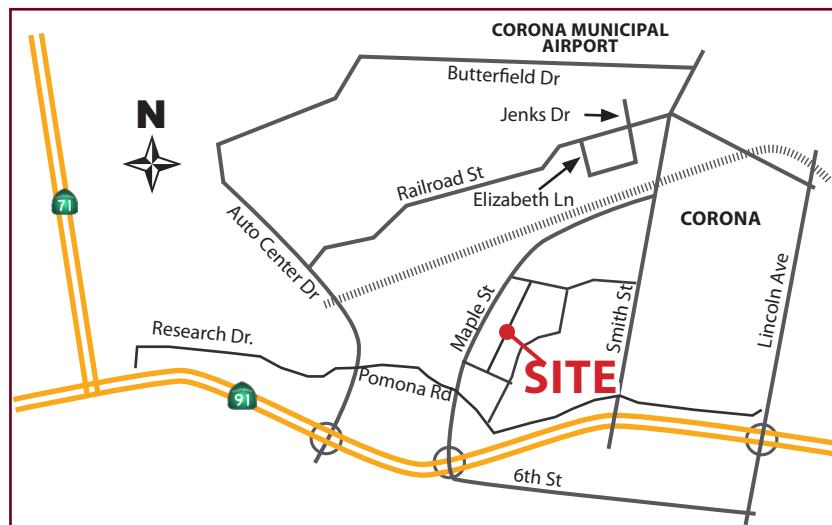

TOBY TEWELL

951.276.3662

TTEWELL@LEERIVERSIDE.COM | DRE# 01822772

JEFF RUSCIGNO, SIOR

951.276.3630

JRUSCIGNO@LEERIVERSIDE.COM | DRE# 01030286

FOR LEASE

±3,466 SF AVAILABLE

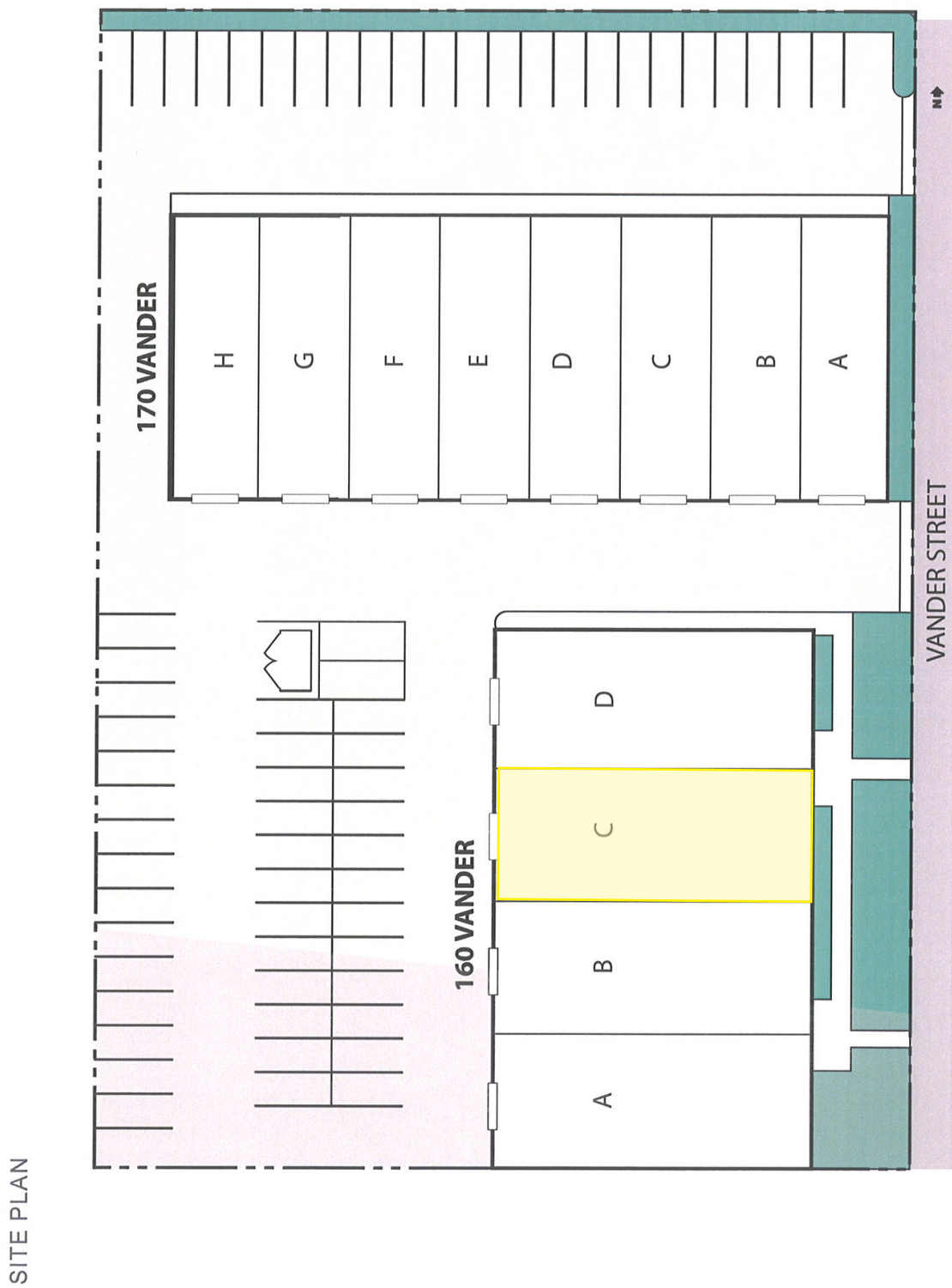

TOBY TEWELL

951.276.3662

TTWELL@LEERIVERSIDE.COM | DRE# 01822772

JEFF RUSCIGNO, SIOR

951.276.3630

JRUSCIGNO@LEERIVERSIDE.COM | DRE# 01030286