

# SILVERHAWK BUSINESS PARK

## OFFICE SUITES FOR LEASE

30111, 30123 & 30135 TECHNOLOGY DRIVE - MURRIETA, CA



### PROPERTY HIGHLIGHTS:

- Office Suites From  $\pm 2,388$  to  $\pm 3,997$  SF
- Immediate Occupancy
- Elevator Served
- All Suites Fully Improved

**LEASE RATES FROM  
\$1.50 PSF/MO. MODIFIED GROSS**



**JIM NADAL, CCIM • 951.445.4520 • jnadal@leetemecula.com • DRE #01040679**

# SILVERHAWK BUSINESS PARK

## OFFICE SUITES FOR LEASE

30111, 30123 & 30135 TECHNOLOGY DRIVE - MURRIETA, CA



### 30111 TECHNOLOGY DRIVE

SUITE #	SIZE ±RSF	LEASE RATE	DESCRIPTION
---------	-----------	------------	-------------

100% LEASED

### 30123 TECHNOLOGY DRIVE

100% LEASED

### 30135 TECHNOLOGY DRIVE

210	±2,388	\$1.50/SF MG	Immediate Occupancy. Call agent for touring instructions.
230	±3,997	\$1.50/SF MG	Immediate Occupancy. Call agent for touring instructions.
240	±3,474	\$1.50/SF MG	Immediate Occupancy. Call agent for touring instructions.

REV: 02/19/2025

**JIM NADAL, ccim • 951.445.4520 • jnadal@leetemecula.com • DRE #01040679**



# SILVERHAWK BUSINESS PARK

## OFFICE SUITES FOR LEASE

30111, 30123 & 30135 TECHNOLOGY DRIVE - MURRIETA, CA

### 30135 TECHNOLOGY DR

FIRST FLOOR

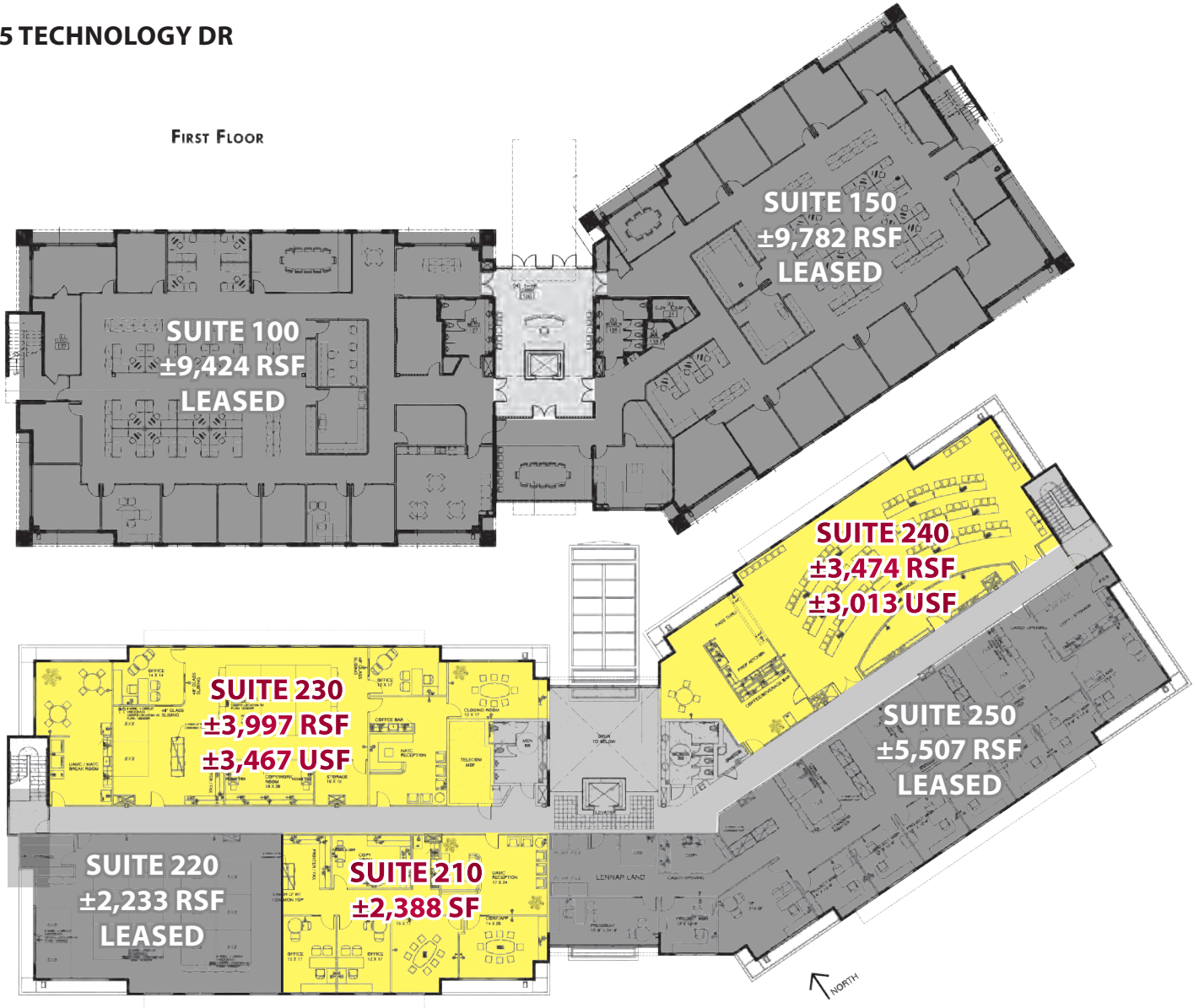

### 30135 TECHNOLOGY DRIVE

SUITE #	SIZE ±RSF	LEASE RATE	DESCRIPTION
210	±2,388	\$1.50/SF MG	Immediate Occupancy. Call agent for touring instructions.
230	±3,997	\$1.50/SF MG	Immediate Occupancy. Call agent for touring instructions.
240	±3,474	\$1.50/SF MG	Immediate Occupancy. Call agent for touring instructions.

**JIM NADAL, CCIM • 951.445.4520 • jnadal@leetemecula.com • DRE #01040679**

No warranty or representation has been made to the accuracy of the foregoing information. Terms of sale or lease and availability are subject to change or withdrawal without notice.

Lee & Associates Commercial Real Estate Services, Inc. - Riverside. 25240 Hancock Avenue, Suite 100 - Murrieta, CA 92562 | Corporate ID# 01048055



# SILVERHAWK BUSINESS PARK

## OFFICE SUITES FOR LEASE

30111, 30123 & 30135 TECHNOLOGY DRIVE - MURRIETA, CA



JIM NADAL, ccim • 951.445.4520 • jnadal@leetemecula.com • DRE #01040679