

# ±2,782 SF Industrial Unit for Lease

491 Atlas Street, Brea, CA

EXCELLENT BREA LOCATION | FENCED YARD AREA



# Project Features

Explore industrial convenience in Brea with 491 Atlas Street's  $\pm 2,782$  SF industrial space, seamlessly integrated into a larger  $\pm 6,532$  SF industrial building. The Property features  $\pm 500$  SF office space, including two private offices, 16'-18' warehouse clearance, a grade-level door, and fenced yard area. Nestled in an excellent Brea location and strategically positioned near the 57 Freeway & Imperial Highway, this opportunity is your gateway to a prime industrial efficiency.



## Size Available

$\pm 2,782$  SF  
(Part of Larger  $\pm 6,532$  SF  
Industrial Building)



## Office Space

$\pm 500$  SF Office Area  
(Two Private Offices)



## Warehouse Clearance

16' - 18' Warehouse Clear Height



## Loading

One (1) Grade-Level Door  
(10' x 12')



## Parking

Six (6) Auto Parking Stalls



## Yard

Fenced Yard Area



## Additional Features

Private Restroom & Kitchenette  
Area



## Access

Close Proximity to 57 Freeway &  
Imperial Highway

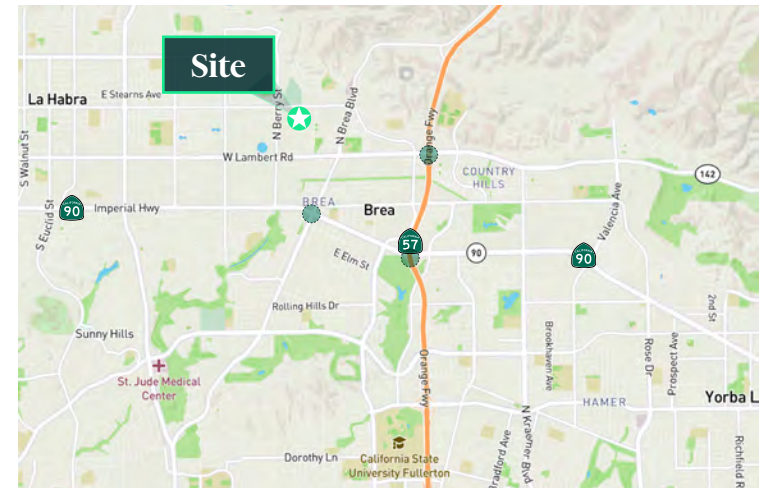

# Site Plan

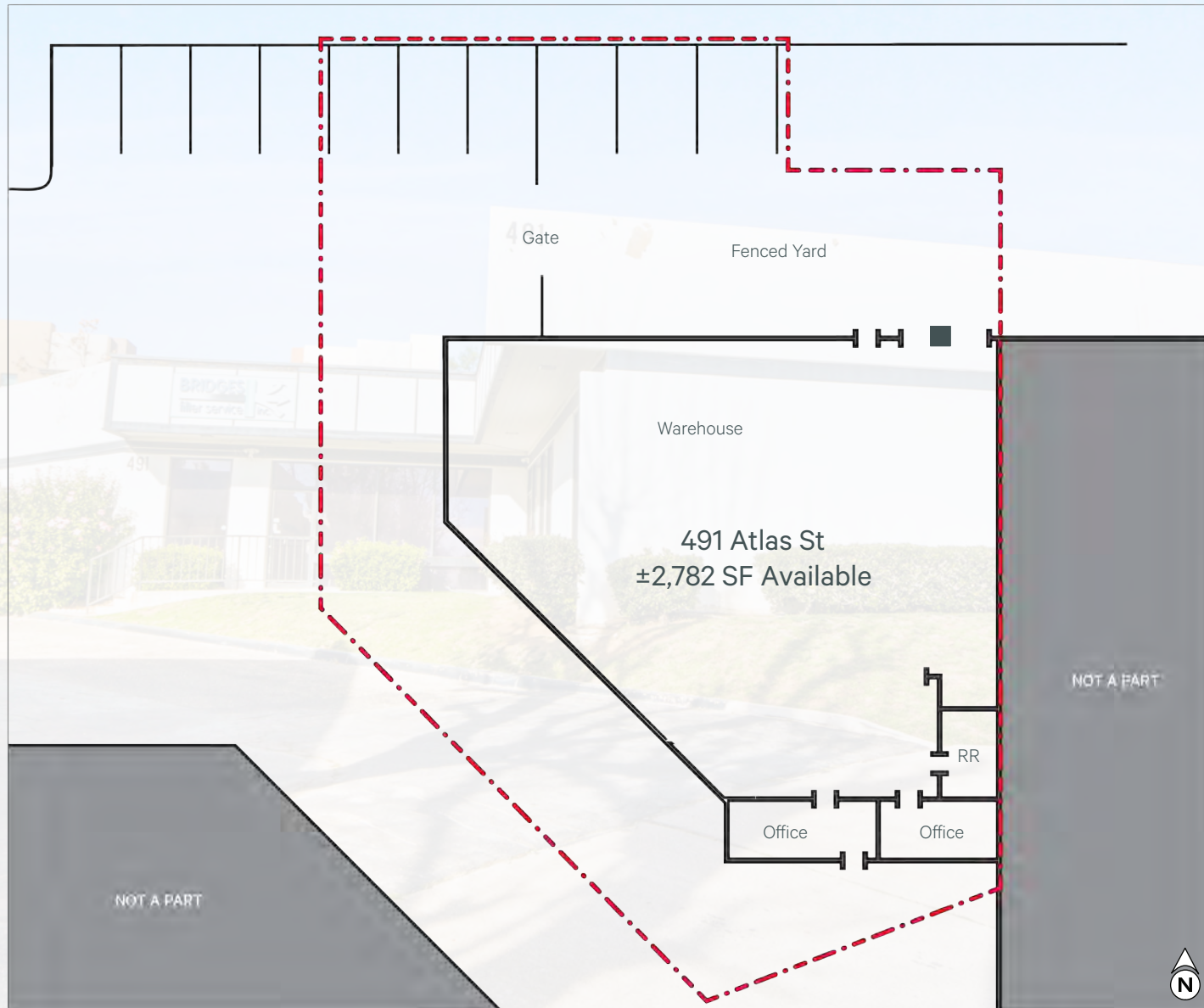



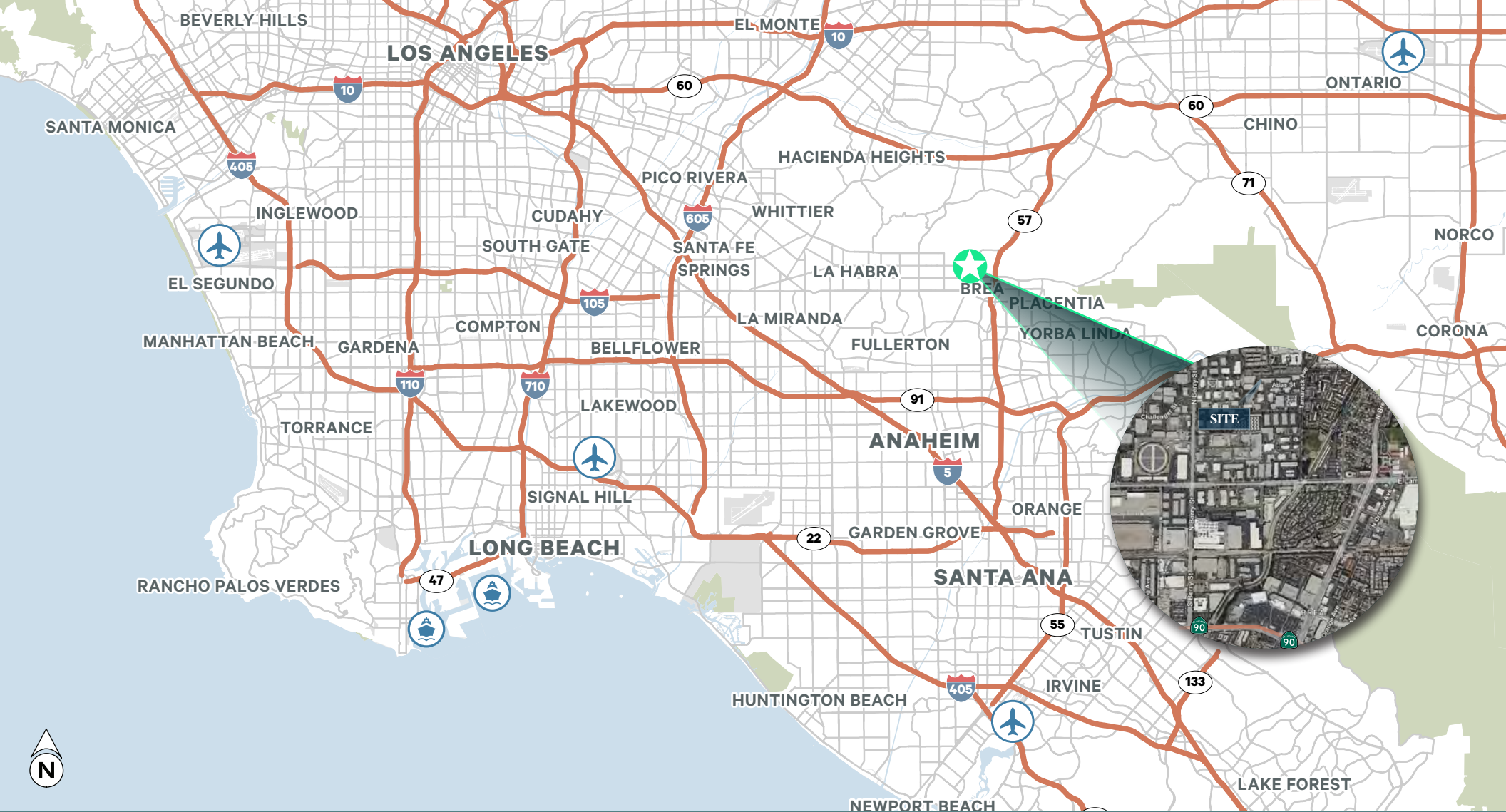

## Contact Us

### Joshua Samuels

Associate  
+1 714 371 9247  
joshua.samuels@cbre.com  
Lic. 02034678

### Oscar Vargas, Jr.

Associate  
+1 714 371 9238  
oscar.vargasjr@cbre.com  
Lic. 02105193

### Keith Greer

Senior Vice President  
+1 714 371 9209  
keith.greer@cbre.com  
Lic. 01899022



© 2024 CBRE, Inc. All rights reserved. This information has been obtained from sources believed reliable, but has not been verified for accuracy or completeness. You should conduct a careful, independent investigation of the property and verify all information. Any reliance on this information is solely at your own risk. CBRE and the CBRE logo are service marks of CBRE, Inc. All other marks displayed on this document are the property of their respective owners, and the use of such logos does not imply any affiliation with or endorsement of CBRE. Photos herein are the property of their respective owners. Use of these images without the express written consent of the owner is prohibited.